

To access the technician menus:

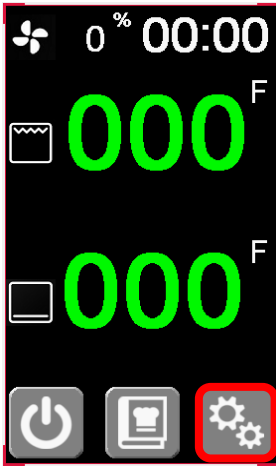

Press the system button on the bottom left corner of the main screen.



Basic

Advanced

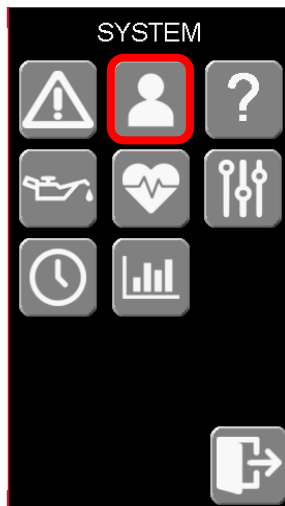
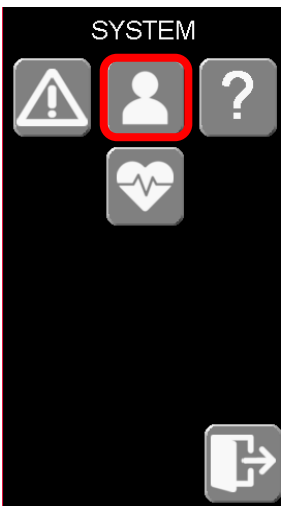

In the system menu, press  to enter the USER menu.

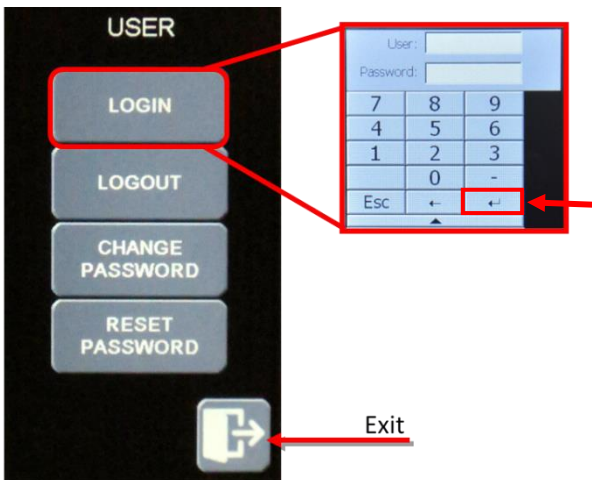

Press the LOGIN button and then login using the following credentials:

User: 2
Password: 911
Enter

If you get an error message, there was a mistake in the credentials.

Press the exit button .



In the system menu, press the INPUTS / OUTPUTS button

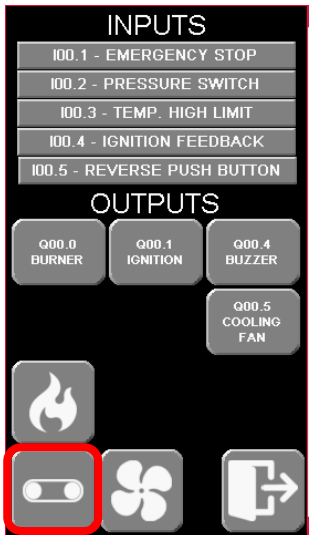

To access the JOG menu, press the conveyor icon

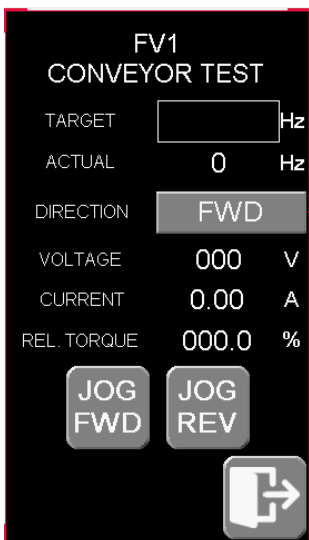

Enter a fix conveyor speed value (10 - 90: 10 low speeds, 90 Hi speed)

Allows you to change the direction of the conveyor (only in this menu).

JOG allows the conveyor to be rotated forward or reverse when the button is pressed. You must hold the button to keep the conveyor in JOG.

Exit

Press JOG REV to jog the conveyor in reverse to find what is likely to cause the jam.

When the conveyor runs smoothly, try the normal operating parameters on the main screen.

Press all exit button  to return to the main screen.