

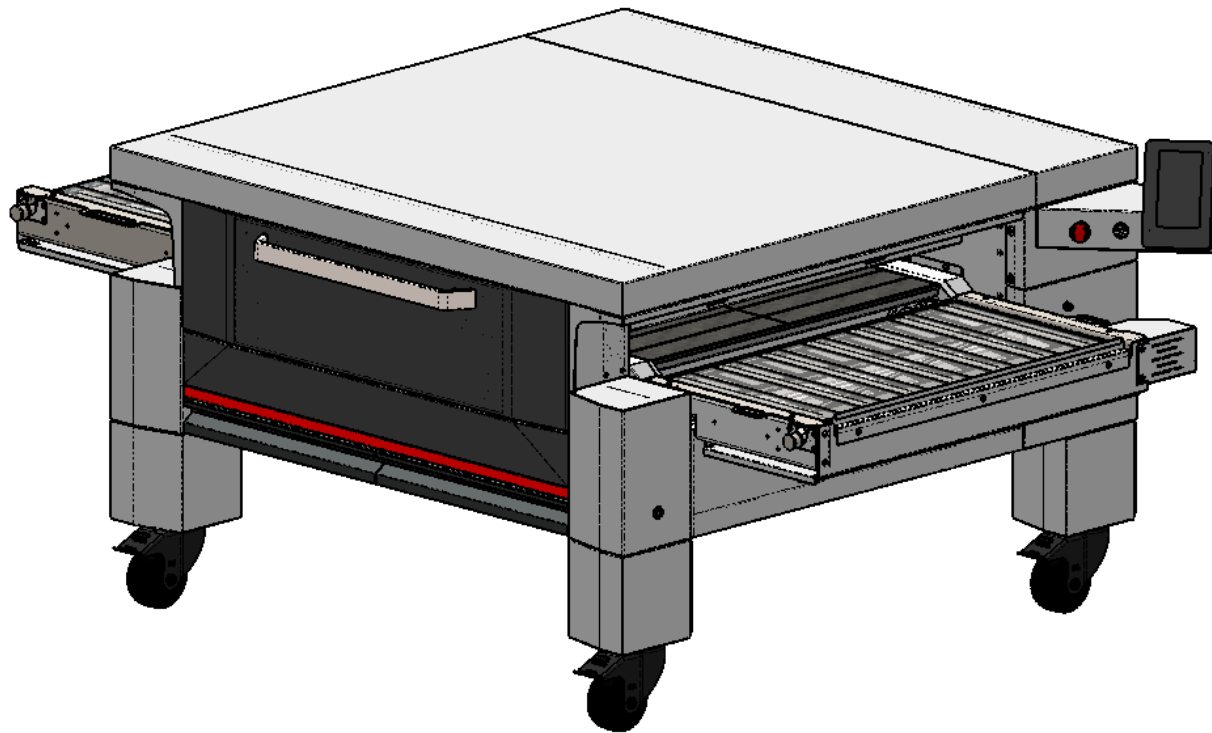

HOT ROCKS

ROCKING EVERYDAY LIFE.



Hot Rocks Oven

Parts Manual

VOLCANO ALL MODELS

A



B*



CONTACT SERVICE DEPARTEMENT FOR OLDER VOLCANO OVEN
IGNITERS BEFORE SERIAL NUMBER 02853082025

#	Part #	Description	Model
A	TO0000610	6 MONTHS MAINTENANCE KIT	ALL
B*	VOL11-0002-A	YEARLY MAINTENANCE KIT FOR NATURAL GAS FOR SERIAL NUMBERS AFTER 02853082025	ALL
B*	VOL11-0073-A	YEARLY MAINTENANCE KIT FOR PROPANE GAS FOR SERIAL NUMBERS AFTER 02853082025	ALL

Description

MAINTENANCE KIT



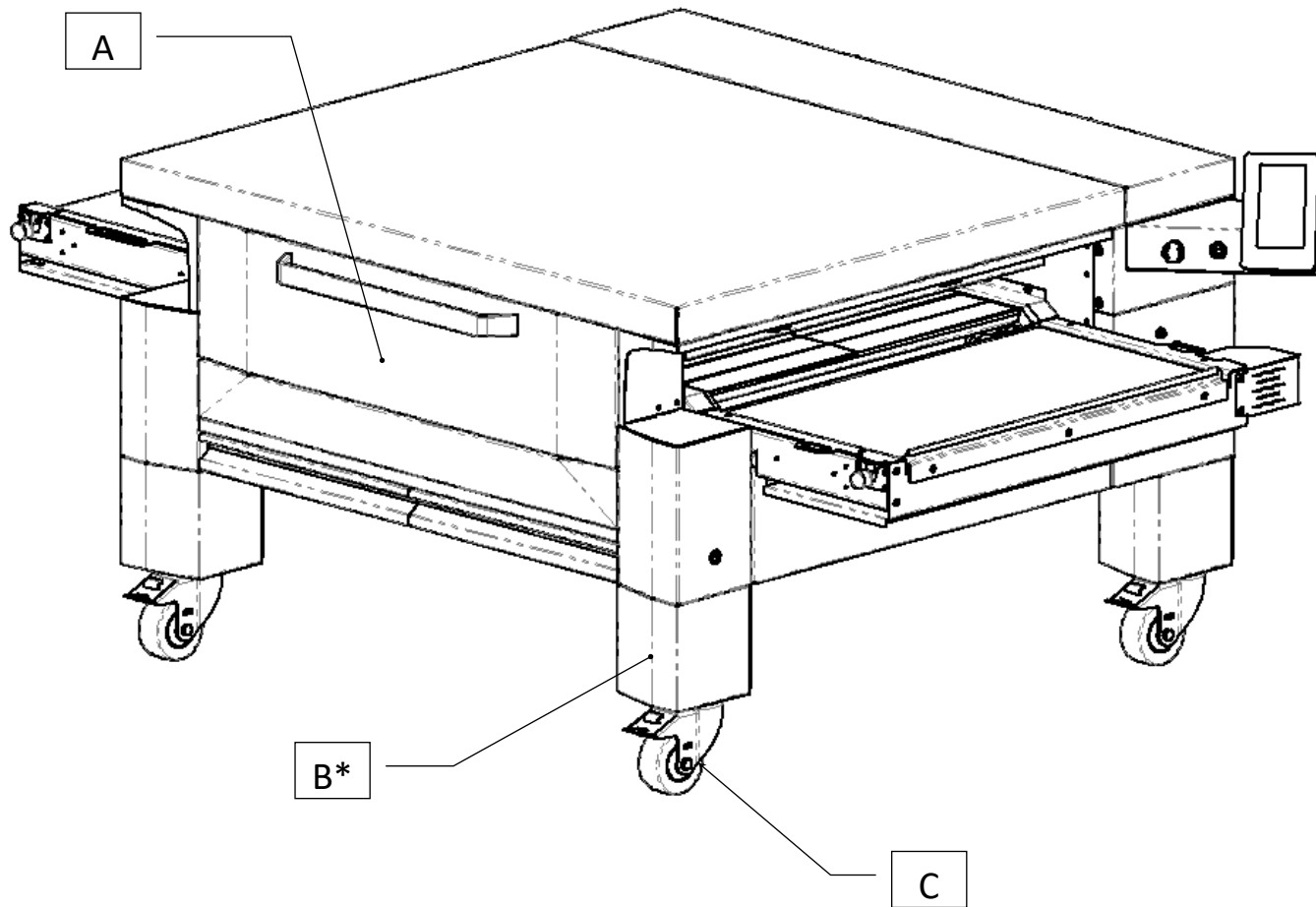

#	Part #	Description	Model
A*	VOL11-0063-A	DOOR WITH HINGES	4000
B*	VOLCANO-LEGS-1-2	SINGLE & DOUBLE STACK LEG KIT	ALL
B*	VOLCANO-LEGS-TRIPLE	TRIPLE STACK LEG KIT	ALL
C	139-0004	CASTERS	ALL

Description

FRONT SECTION 1 OF 3



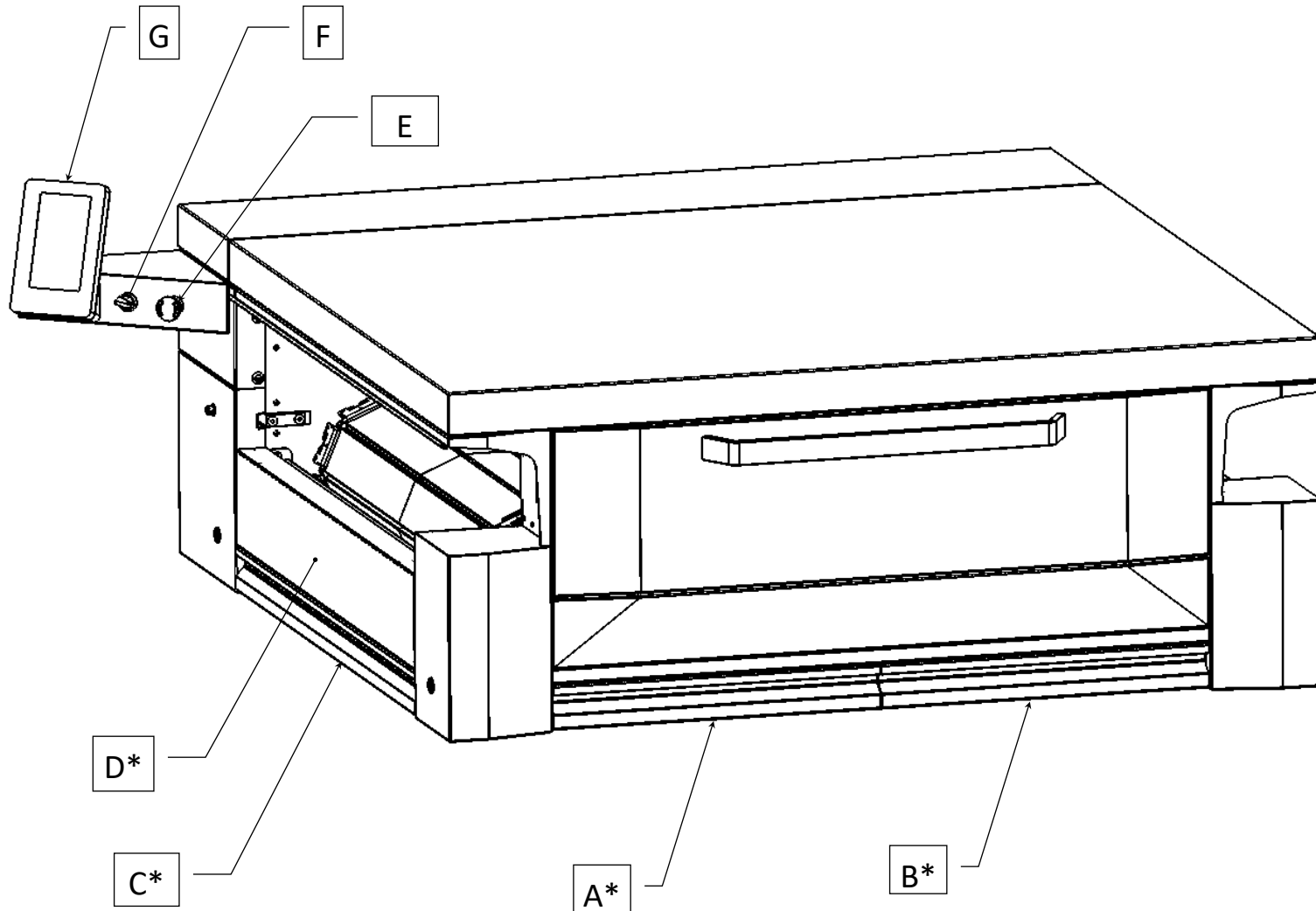

#	Part #	Description	Model
A*	HR05-0492-E	FRONT LEFT CRUMB TRAY	4033
A*		FRONT LEFT CRUMB TRAY	4026
A*		FRONT LEFT CRUMB TRAY	4020
B*	HR05-0493-E	FRONT RIGHT CRUMB TRAY	4033
B*		FRONT RIGHT CRUMB TRAY	4026
B*		FRONT RIGHT CRUMB TRAY	4020
C*	HR05-0613-B	ENTRY/EXIT CRUMB TRAY	XX33
C*		ENTRY/EXIT CRUMB TRAY	XX26
C*		ENTRY/EXIT CRUMB TRAY	XX20
D*	HR05-0474-D	CONVEYOR BOTTOM HOOD	XX33
D*		CONVEYOR BOTTOM HOOD	XX26
D*		CONVEYOR BOTTOM HOOD	XX20
E	026-1410	E-STOP BUTTON	ALL
F	026-1400	TOGGLE DIRECTION SWITCH	ALL
G	VOL11-0011-A	TOUCH CONTROL SCREEN	ALL

* MODEL SPECIFIC

Description

FRONT SECTION—2 of 3



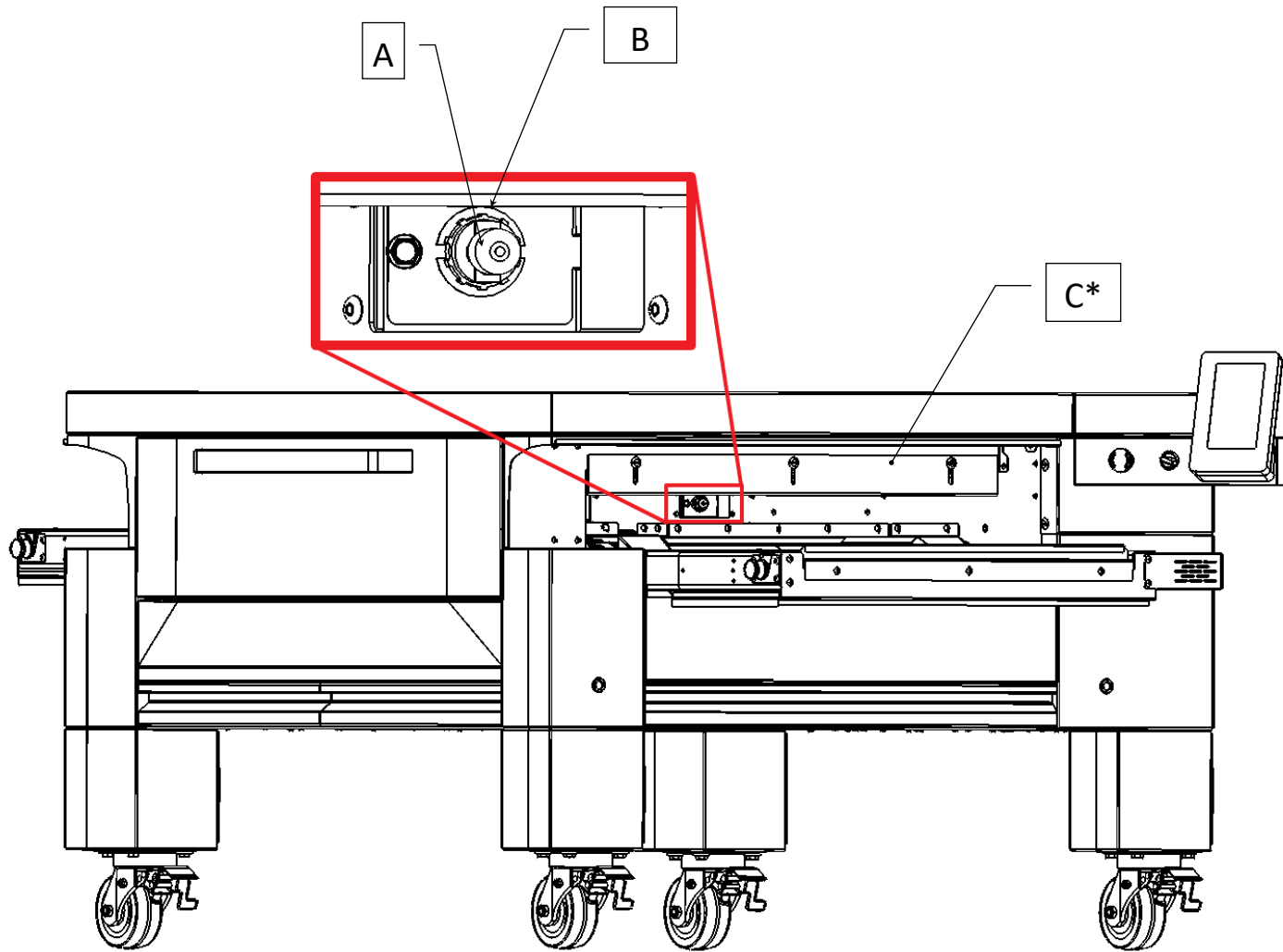

#	Part #	Description	Model
A	172-0004	LIGHT BULB	ALL
B	HR05-0491-B	LIGHT BULB SOCKET ASSEMBLY	ALL
C*	HR01-1506-B	ENTRY EXIT HEAT BAFFLE	XX33
C*		ENTRY EXIT HEAT BAFFLE	XX26
C*		ENTRY EXIT HEAT BAFFLE	XX20

* MODEL SPECIFIC

Description

FRONT SECTION—3 of 3



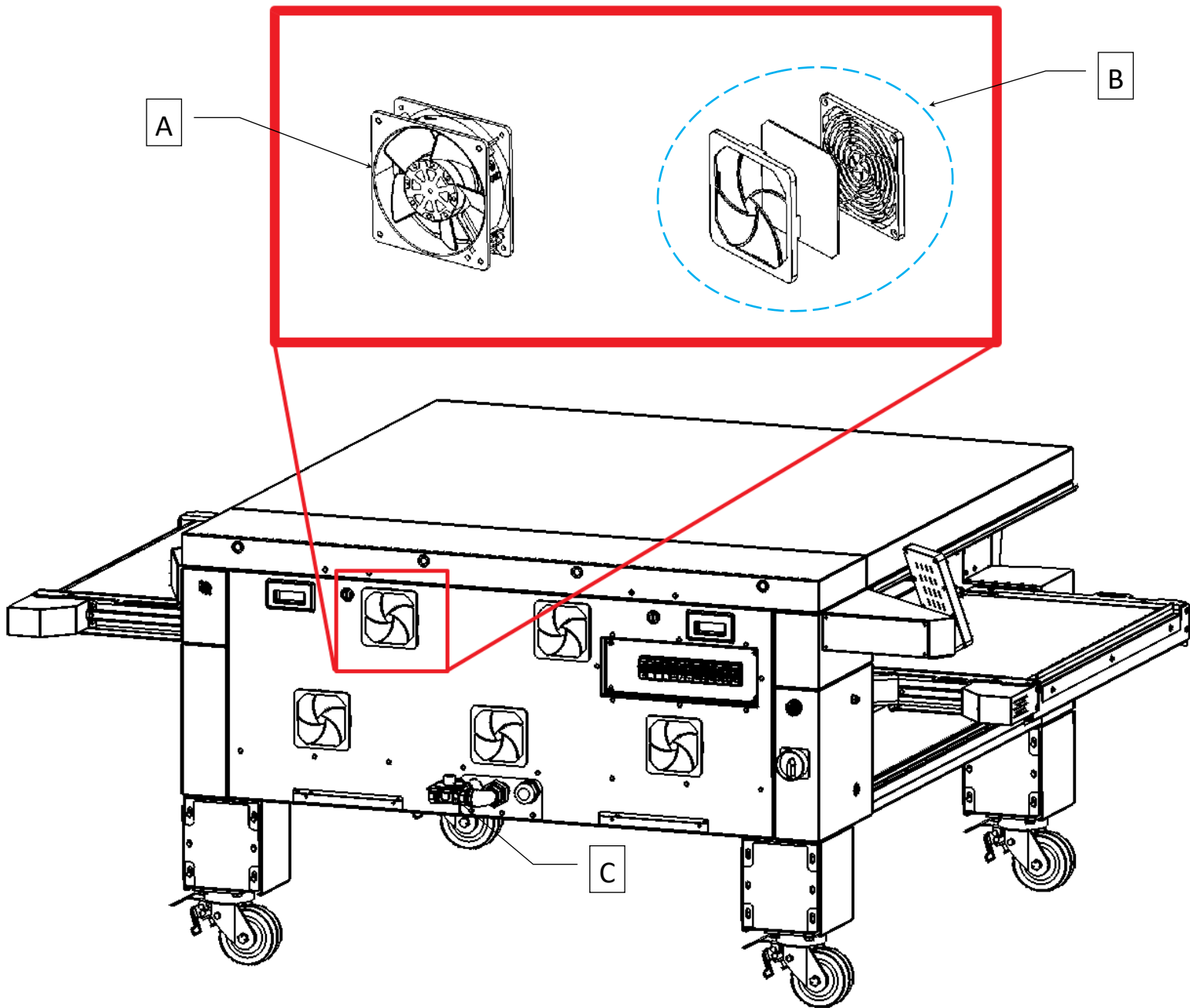

#	Part #	Description	Model
A	VOL11-0017-A	AXIAL PANEL COOLING FAN WITH FILTER	ALL
B	135-0095	FAN FILTER WITH FIXATION ONLY	ALL
C	HR05-0578-A	GAS PRESSURE REGULATOR	ALL

Description

REAR SECTION—1 of 2



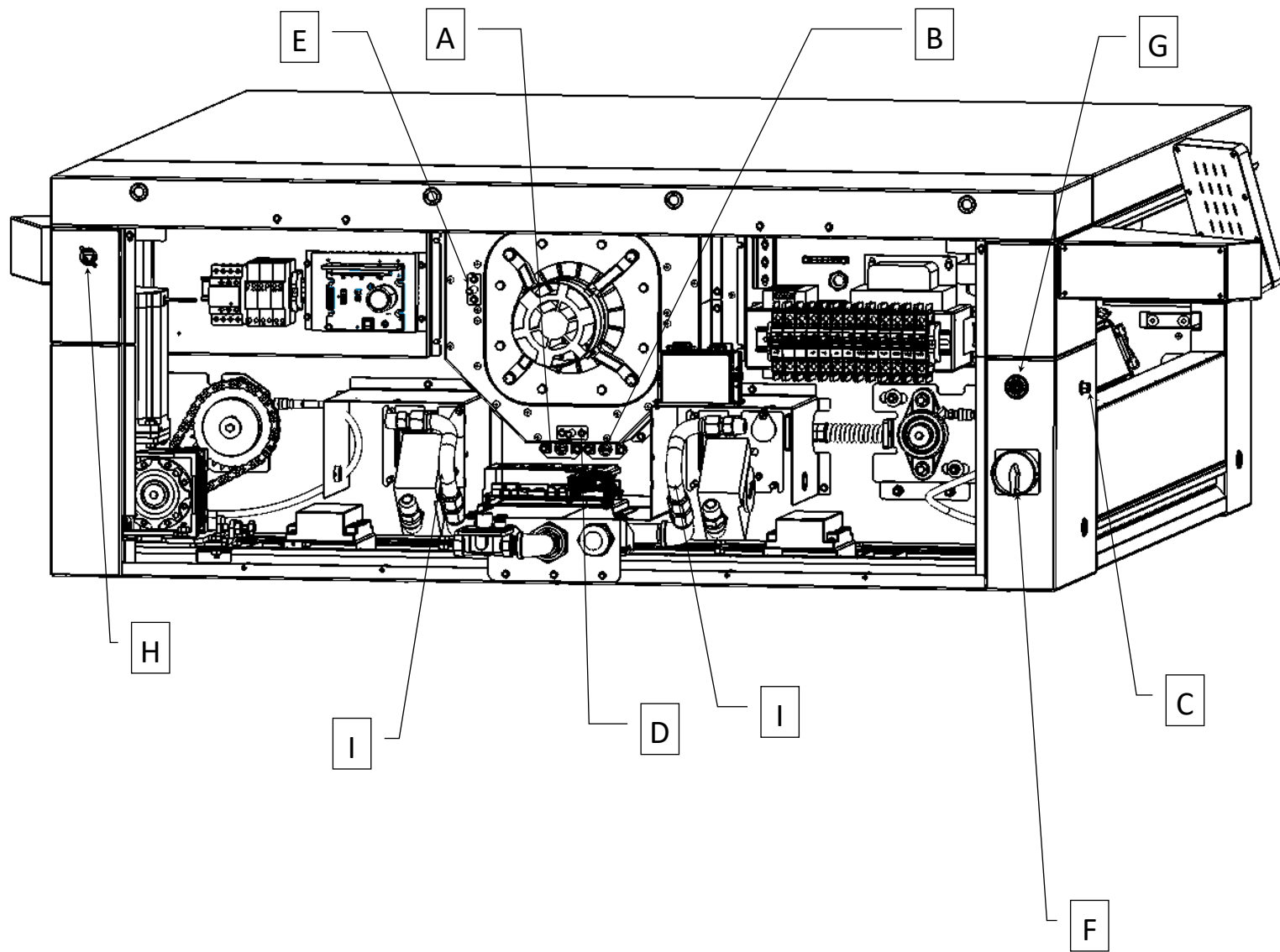

#	Part #	Description	Model
A	VOL11-0013-A	HIGH LIMIT TEMPERATURE SWITCH	ALL
B	VOL11-0014-A	REGULATION TEMPERATURE SWITCH	ALL
C	026-1160	ENTRY EXIT CONVEYOR CONNECTOR	ALL
D	VOL11-0004-A	BOTTOM THERMOCOUPLE TYPE K 12 INCH LONG	ALL
E	VOL11-0003-A	TOP THERMOCOUPLE TYPE K 6 INCH LONG	ALL
F	026-3182	MAIN SWITCH	ALL
G	EL02-0094	BUZZER	ALL
H	036-1000	ETHERNET CONNECTOR	ALL
I	PL29-0123	FLEXIBLE GAS HOSE	ALL

Description

REAR SECTION—2 of 2



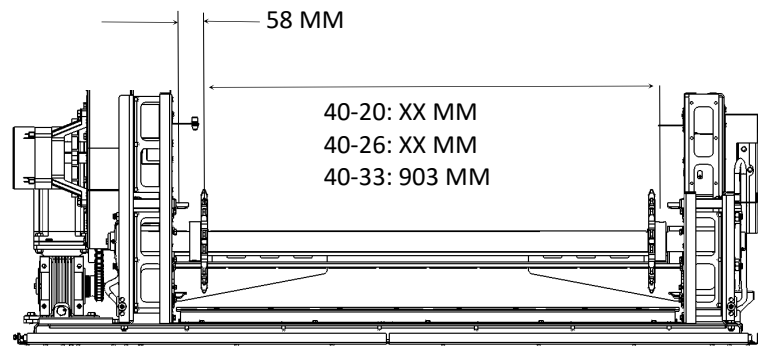
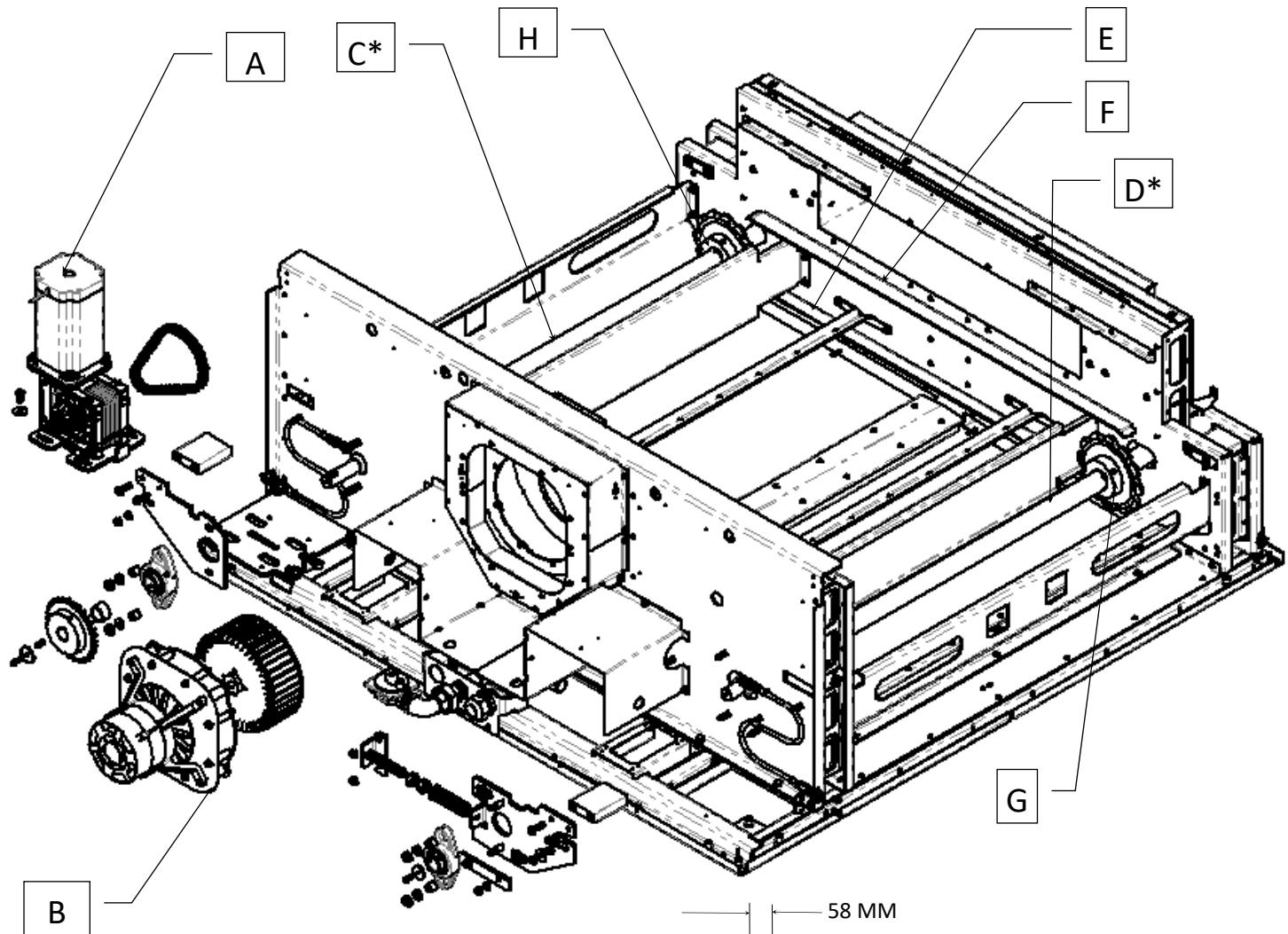

#	Part #	Description	Model
A	VOL11-0021-A	CONVEYOR MOTOR & GEARBOX ASSEMBLY	ALL
B	HR11-0061-A	CONVECTION FAN WITH MOTOR ASSEMBLY	ALL
C*	HR02-0224-A	DRIVING SHAFT	XX33
C*		DRIVING SHAFT	XX26
C*		DRIVING SHAFT	XX20
D*	HR02-0225-C	IDLER SHAFT	XX33
D*		IDLER SHAFT	XX26
D*		IDLER SHAFT	XX20
E	HR01-1464-C	LOWER TRACK	40XX
F	HR01-1463-C	UPPER TRACK	40XX
G	HR04-0273-C	MAIN CONVEYOR SPROCKET	ALL
H	HR02-0191-A	MACHINE KEY STOCK 3/8" X 3/8" X 2"	ALL

* MODEL SPECIFIC

Description

MECHANICS—1 of 4



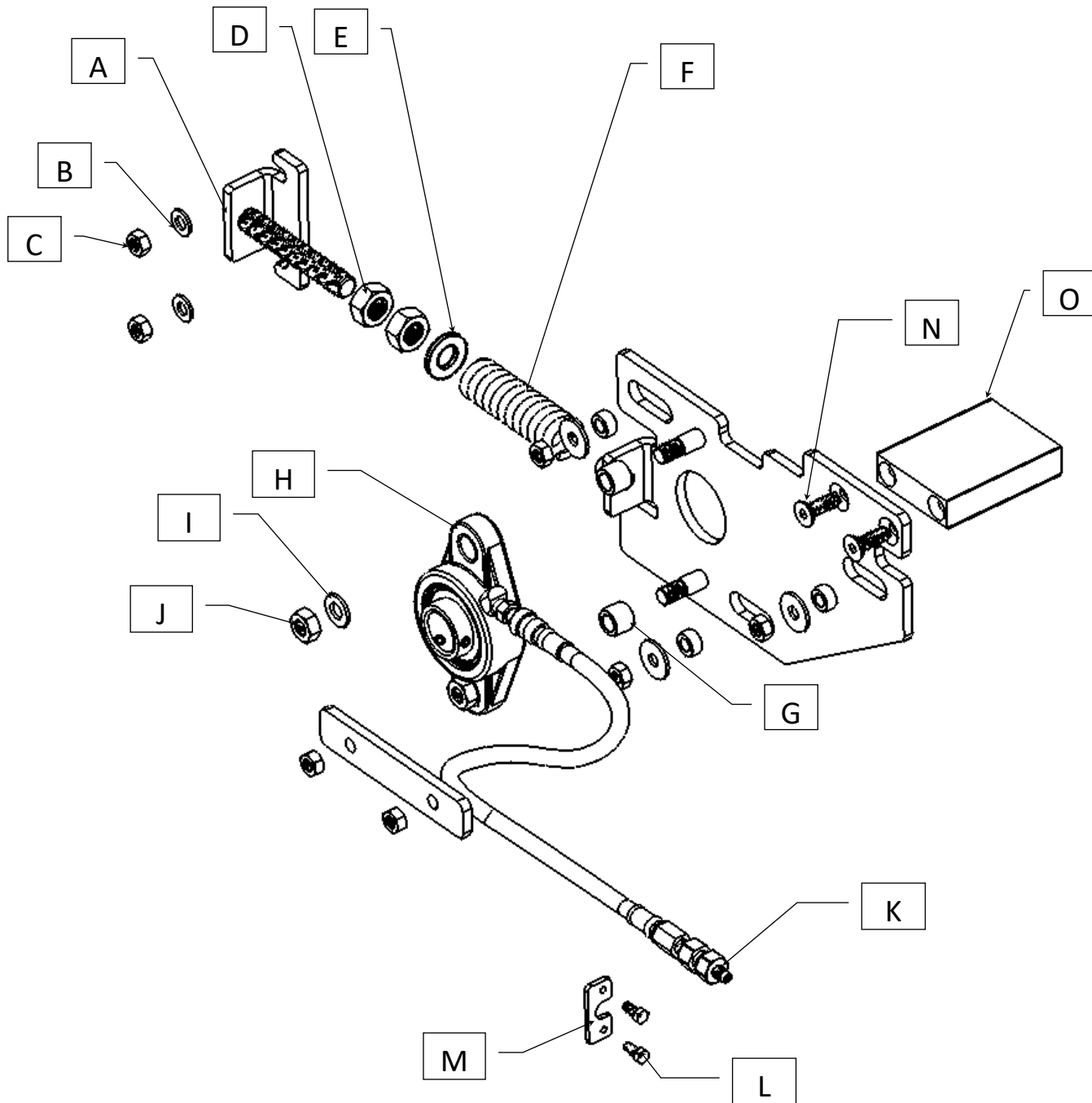

#	Part #	Description	Model
A	HR04-0309-A	TENSIONNER THREADED ROD ASSEMBLY	ALL
B	052-2053	TENSIONNER WASHER M8 ZINC PLATED	ALL
C	052-4560	TENSIONNER NUT M8X1.25 ZINC PLATED	ALL
D	052-4568	ROD NUT M14X2.0 ZINC PLATED	ALL
E	052-2057	ROD WASHER M14 ZINC PLATED	ALL
F	QU28-0156	SPRING	ALL
G	HR02-0009-A	BEARING SLEEVE	ALL
H	HR11-0072-A	HIGH TEMPERATURE BEARING	ALL
I	052-2054	BEARING WASHER M10 ZINC PLATED	ALL
J	052-4563	BEARING NUT M10X1.5 ZINC PLATED	ALL
K	VOL11-0064-A	GREASING TUBE	ALL
L	052-4065	BOLT M5X0.8 12MM	ALL
M	HR01-1688-A	GREASE TUBE FIXATION PLATE	ALL
N	053-0925	COUNTERSUNK SOCKET HEX SCREW M8X1.25 25MM ZINC PLATED	ALL
O	HR02-0169-A	ENTRY/EXIT CONVEYOR FIXATION BLOC	ALL

*MODEL SPECIFIC

Description

MECHANICS—3 of 4



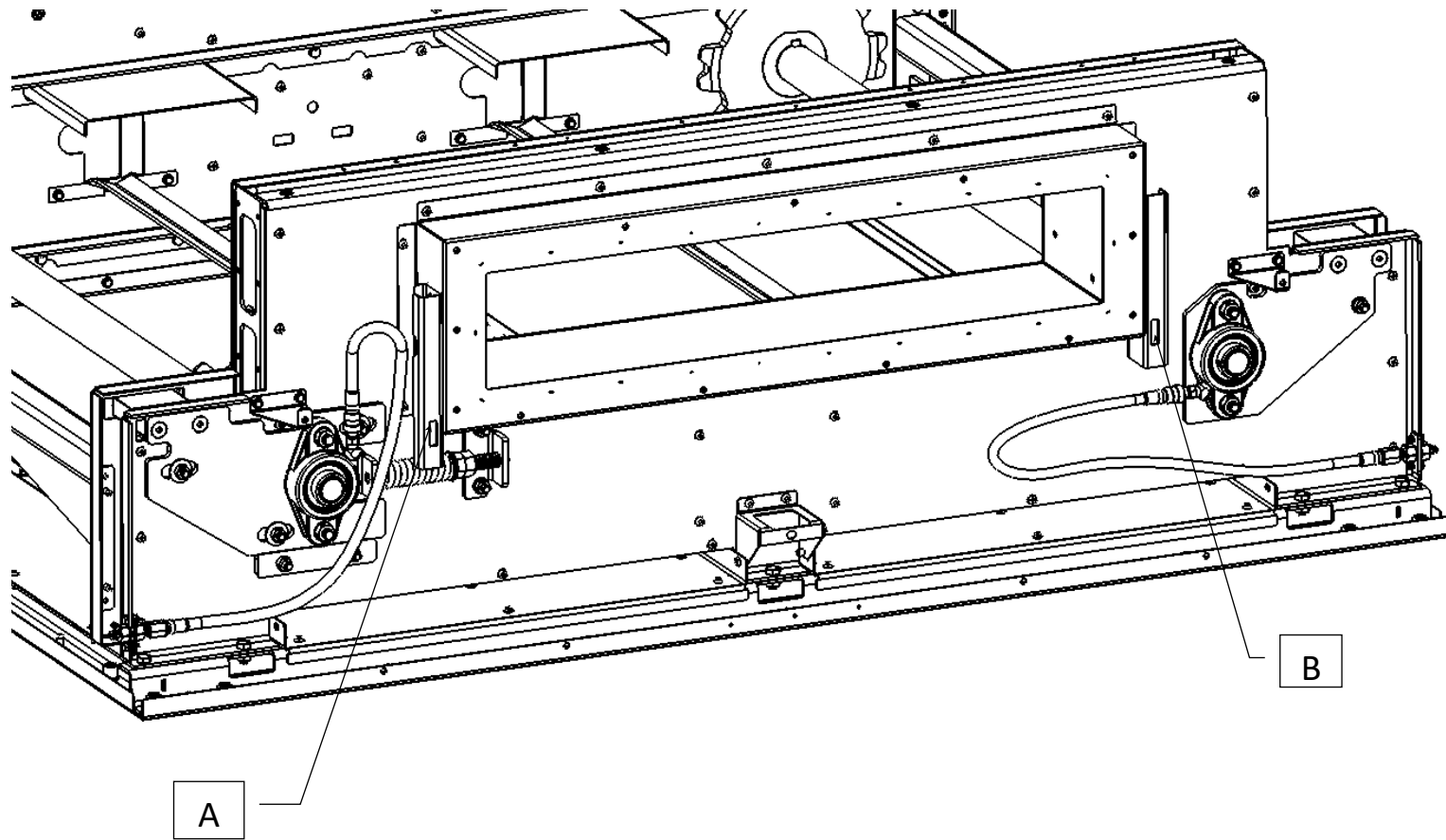

#	Part #	Description	Model
A	HR01-1845-A	FRONT DOOR HINGE FIXATION LEFT SIDE	ALL
B	HR01-1675-C	FRONT DOOR HINGE FIXATION RIGHTSIDE	ALL

*MODEL SPECIFIC

Description

MECHANICS—4 of 4



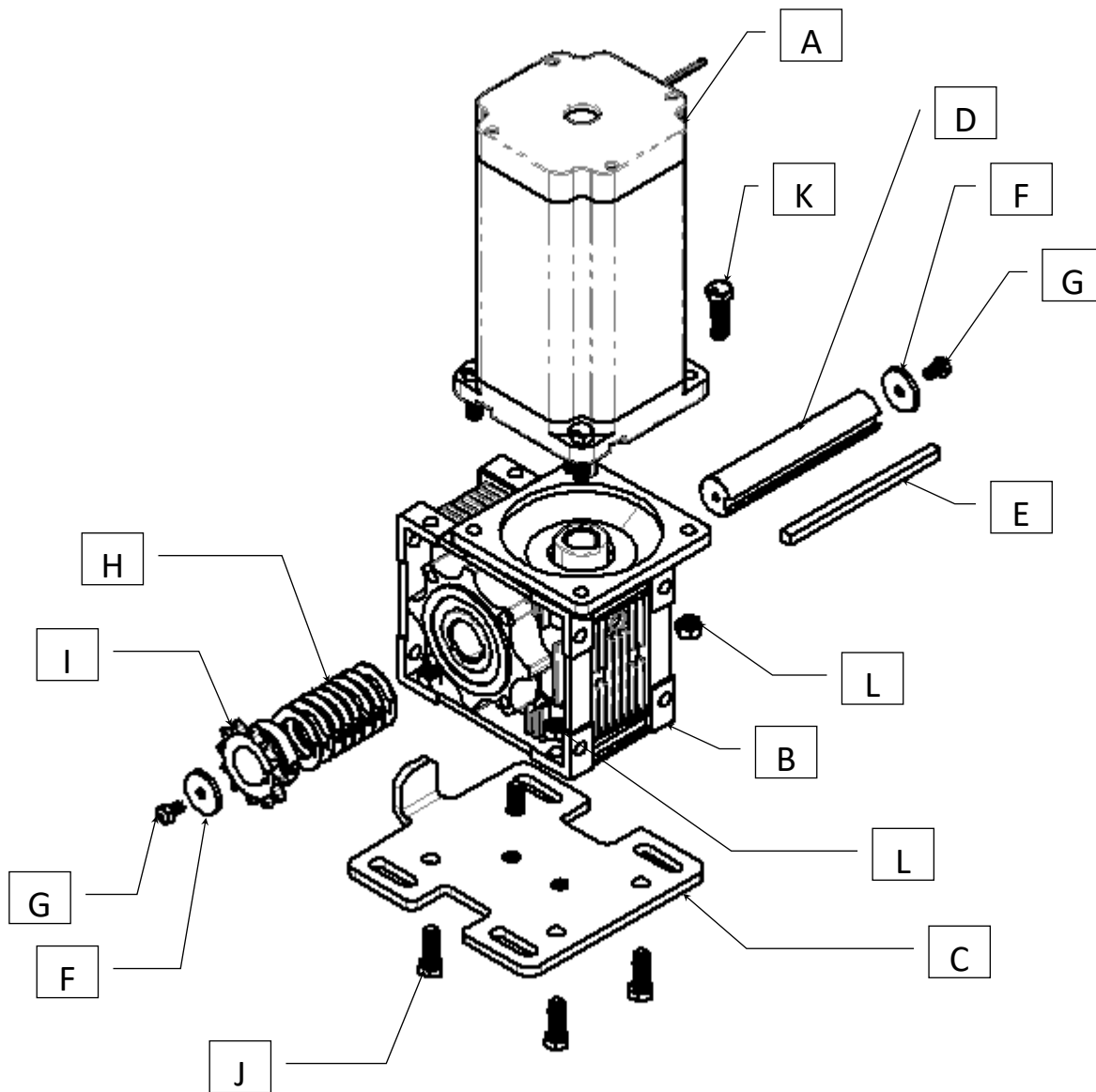

#	Part #	Description	Model
A	VOL11-0021-A	STEPPER MOTOR NEMA 42	ALL
B	VOL11-0024-A	GEARBOX (037-6016)	ALL
C	HR04-0379-A	BASE PLATE	ALL
D	HR02-0234-A	GEARBOX SHAFT	ALL
E	HR02-0183-A	GEARBOX KEY	ALL
F	HR01-1093-A	SHAFT WASHER	ALL
G	052-4071	END SHAFT BOLT	ALL
H	HR01-1404-A	GEARBOX SHAFT SPACER	ALL
I	080-0092	GEARBOX SPROCKET	ALL
J	052-4215	BOLT HEX M8X1.25 25MM ZINC PLATED	ALL
K	052-4225	BOLT HEX M8X1.25 35MM ZINC PLATED	ALL
L	052-4560	NUT M8X1.25 ZINC PLATED	ALL

* MODEL SPECIFIC

Description

MOTOREDUCER ASSEMBLY — 1 OF 1



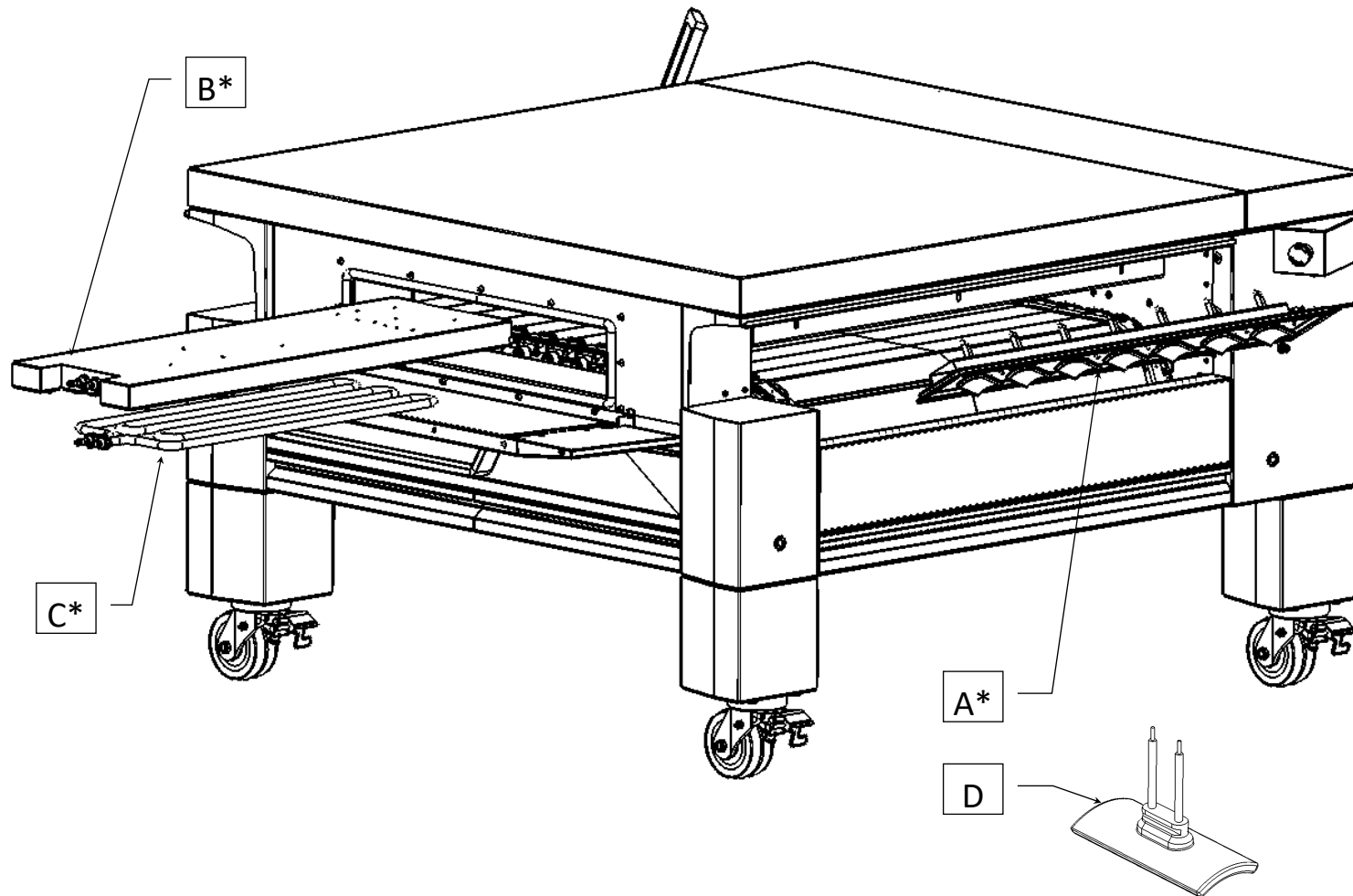

#	Part #	Description	Model
A*	VOL11-0027-A	RADIANT CARTRIDGE	XX33
A*		RADIANT CARTRIDGE	XX26
A*		RADIANT CARTRIDGE	XX20
B*	VOL11-0009-A	TUBULAR HEATER CARTRIDGE	XX33
B*		TUBULAR HEATER CARTRIDGE	XX26
B*		TUBULAR HEATER CARTRIDGE	XX20
C*	VOL11-0010-A	TUBULAR ELEMENT ONLY	XX33
C*		TUBULAR ELEMENT ONLY	XX26
C*		TUBULAR ELEMENT ONLY	XX20
D	039-0801	RADIANT ELEMENT ONLY	ALL

*MODEL SPECIFIC

**FOR MODEL BEFORE SERIAL NUMBER 02767022025 REPLACE COMPLETE TUBULAR HEATER CARTRIDGE. ELEMENT ONLY IS NOT COMPATIBLE

Description

TOP HEATER —1 of 1



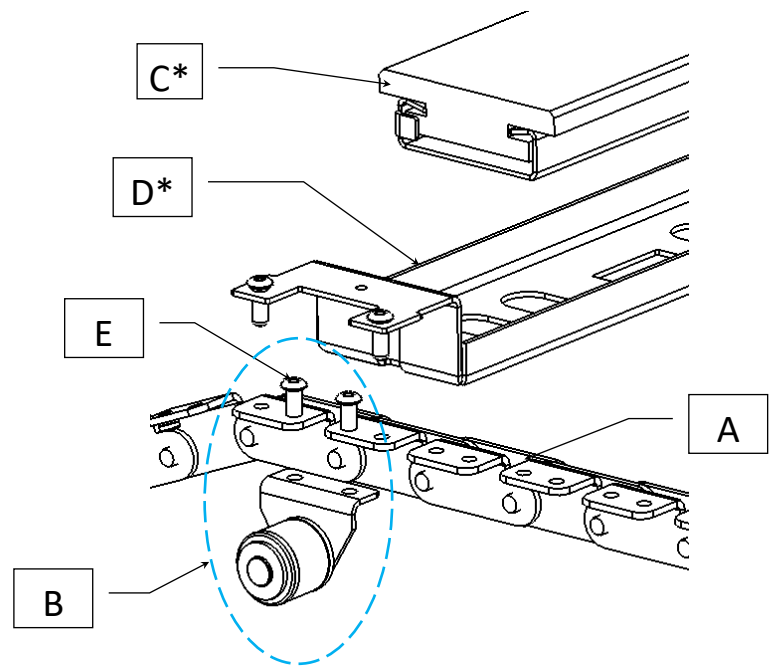
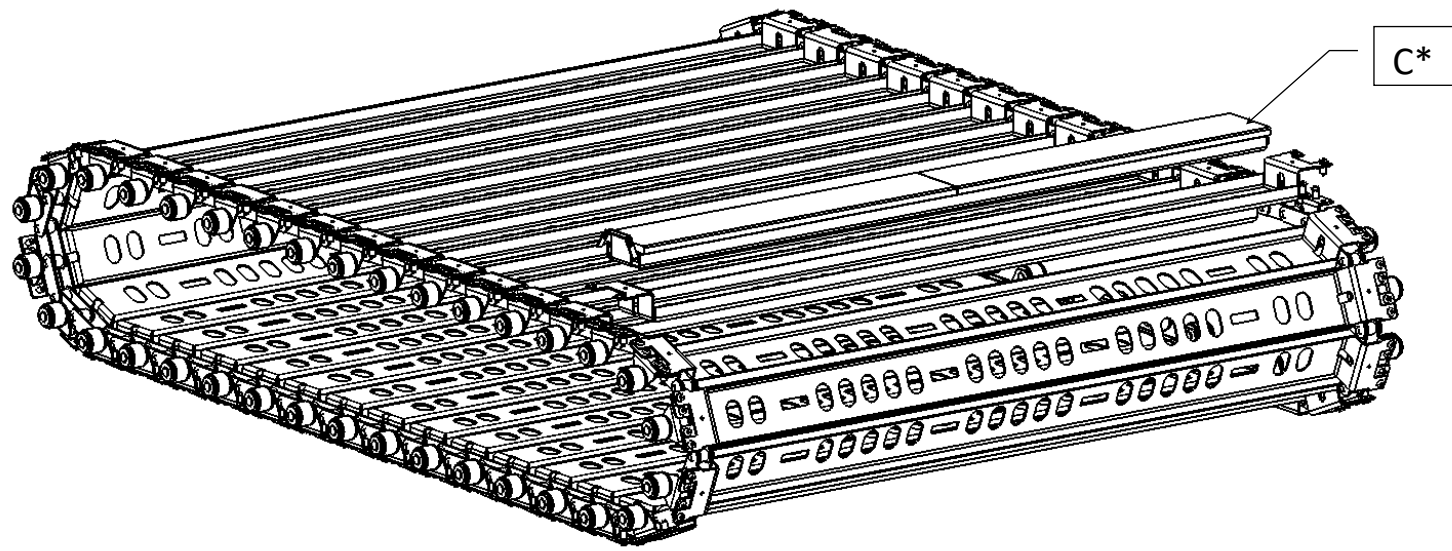

#	Part #	Description	Model
A	080-2811	CHAIN ASSEMBLY	40XX
B	VOL11-0061-A	ROLLER ASSEMBLY WITH RIVETS (SERIAL NUMBER AFTER 02767022025)	ALL
C*	VOL11-0041-A	INTERNAL HOLDERS WITH STONES (PACK OF 3)	XX33
C*		INTERNAL HOLDERS WITH STONES (PACK OF 3)	XX26
C*		INTERNAL HOLDERS WITH STONES (PACK OF 3)	XX26
D*	HR01-1591-E	EXTERNAL HOLDER	XX33
D*		EXTERNAL HOLDER	XX26
D*		EXTERNAL HOLDER	XX26
E	055-1555	SEALING BLIND CLOSED END RIVETS 3/16 X 0.5 STAINLESS GRIP RANGE 0.188" TO 0.25"	ALL

*MODEL SPECIFIC

Description

STONE CONVEYOR



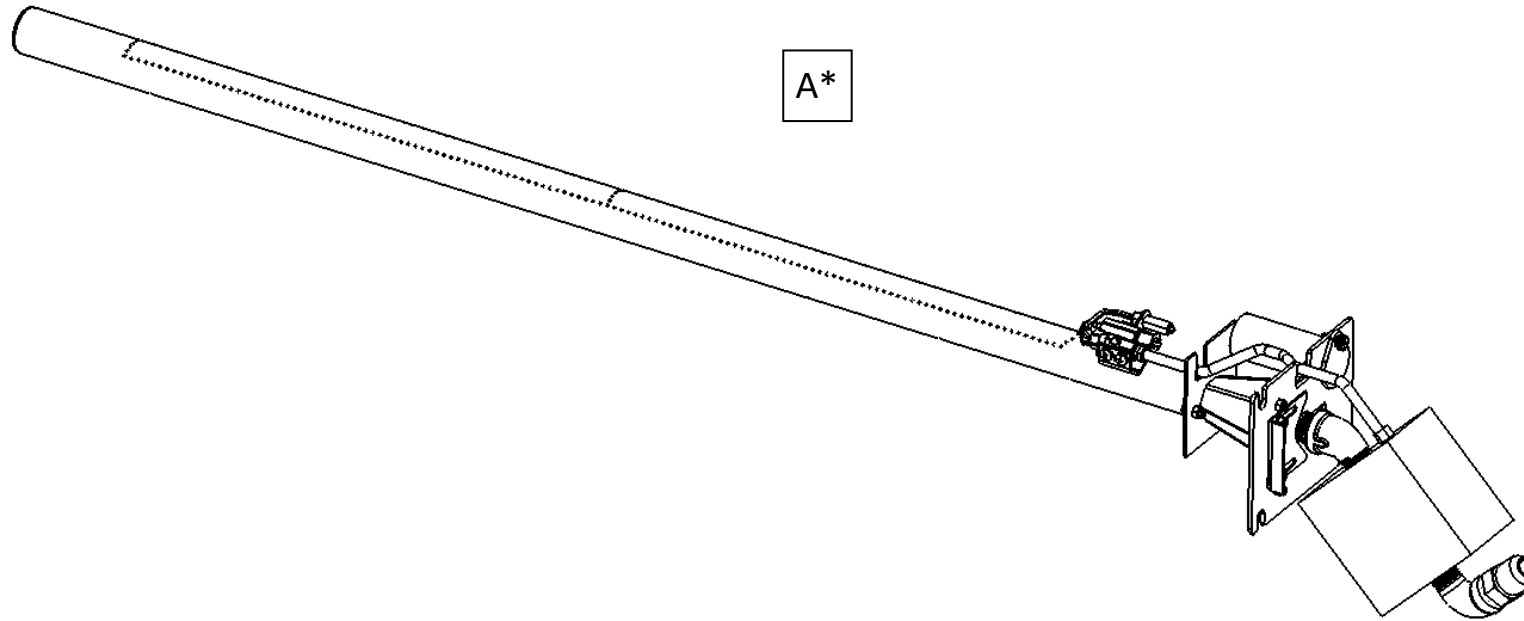

*MODEL SPECIFIC

**DO NOT REPLACE HOT SURFACE IGNITOR ONLY, MODEL MAY VARY. TO ENSURE COMPATIBILITY ALWAYS REPLACE COMPLETE ASSEMBLY.

#	Part #	Description	Model
A*	VOL11-0015-A	COMPLETE BURNER - NATURAL GAS SERIAL NUMBER BEFORE 02767022025	XX33
A*	VOL11-0040-A	COMPLETE BURNER - NATURAL GAS SERIAL NUMBER BETWEEN 02767022025 & 02853082025	XX33
A*	VOL11-0066-A	COMPLETE BURNER - NATURAL GAS SERIAL NUMBER AFTER 02853082025	XX33
A*		COMPLETE BURNER - NATURAL GAS	XX26
A*		COMPLETE BURNER - NATURAL GAS	XX20
A*	VOL11-0016-A	COMPLETE BURNER - PROPANE GAS SERIAL NUMBER BEFORE 02767022025	XX33
A*	VOL11-0039-A	COMPLETE BURNER - PROPANE GAS SERIAL NUMBER BETWEEN 02767022025 & 02853082025	XX33
A*	VOL11-0067-A	COMPLETE BURNER - PROPANE GAS SERIAL NUMBER AFTER 02853082025	XX33
A*		COMPLETE BURNER - PROPANE GAS	XX26
A*		COMPLETE BURNER - PROPANE GAS	XX20

Description

GAS BURNER AND BLOWER VALVE 1 OF 4



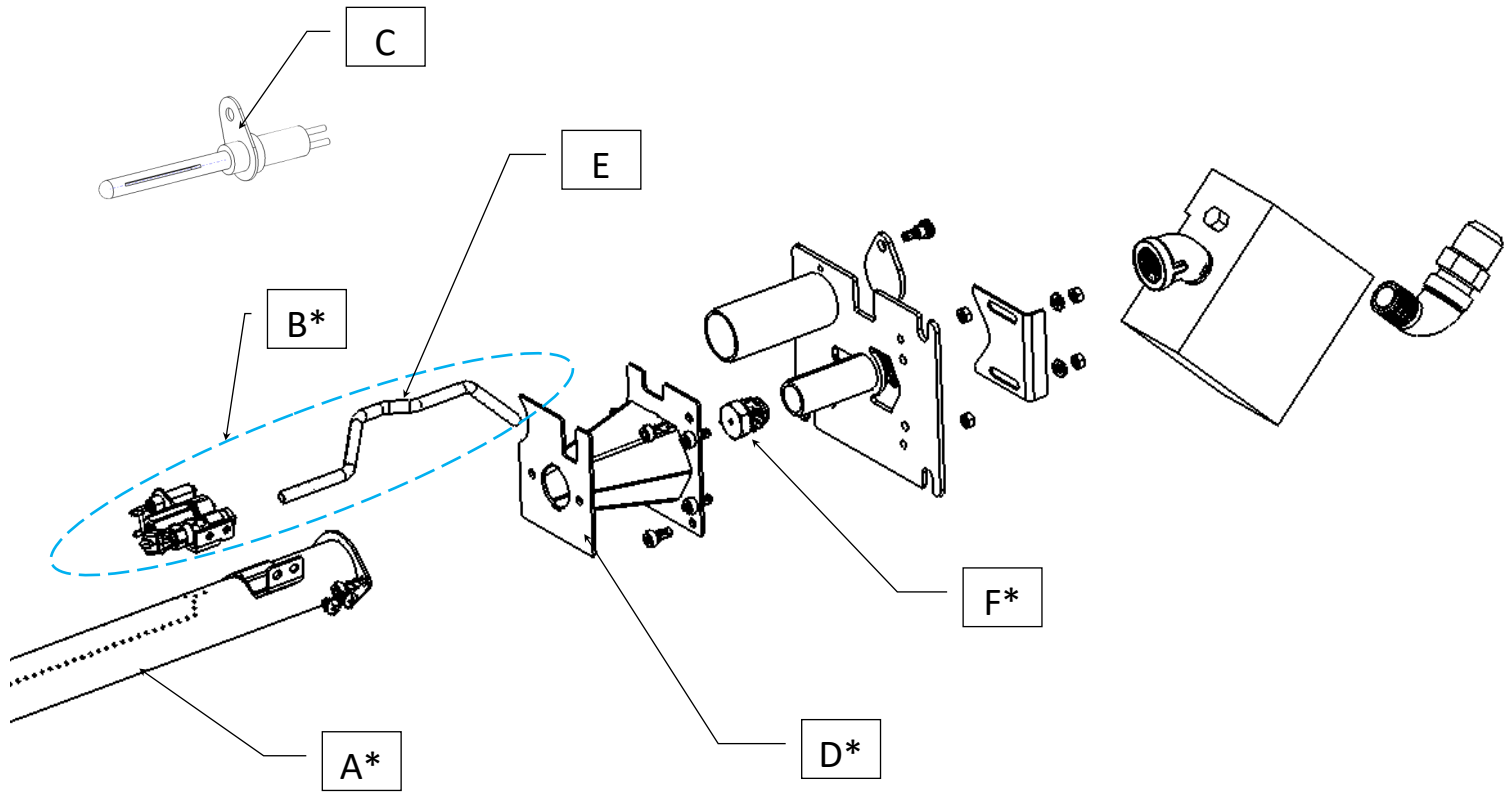

#	Part #	Description	Model
A*	VOL11-0043-A	BURNER TUBE ONLY SERIAL NUMBER BEFORE 02767022025	XX33
A*	VOL11-0044-A	BURNER TUBE ONLY SERIAL NUMBER AFTER 02767022025	XX33
A*		BURNER TUBE ONLY	XX26
A*		BURNER TUBE ONLY	XX20
B*	VOL11-0069-A	FLAME ROD, HOT SURFACE IGNITER & PILOT FLAME ASSEMBLY FOR NATURAL GAS SERIAL NUMBER AFTER 02767022025	ALL
B*	VOL11-0072-A	FLAME ROD, HOT SURFACE IGNITER & PILOT FLAME ASSEMBLY FOR PROPANE GAS SERIAL NUMBER AFTER 02767022025	ALL
C	VOL11-0036-A	HOT SURFACE IGNITER ONLY PACK OF 2 FOR SERIAL NUMBER BEFORE 02767022025	ALL
D*	HR04-0279-B	BURNER VENTURI CONE SERIAL NUMBER BEFORE 02767022025	ALL
D*	HR04-0279-C	BURNER VENTURI CONE SERIAL NUMBER AFTER 02767022025	ALL
E	HR02-0276-B	PILOT FLAME TUBE	ALL
F*	HR02-0320-A	NATURAL GAS 3MM NOZZLE ORRIFICE	ALL
F*	HR02-0239-A	PROPANE GAS 2.5MM NOZZLE ORRIFICE	ALL

Description

GAS BURNER AND BLOWER VALVE 2 OF 4



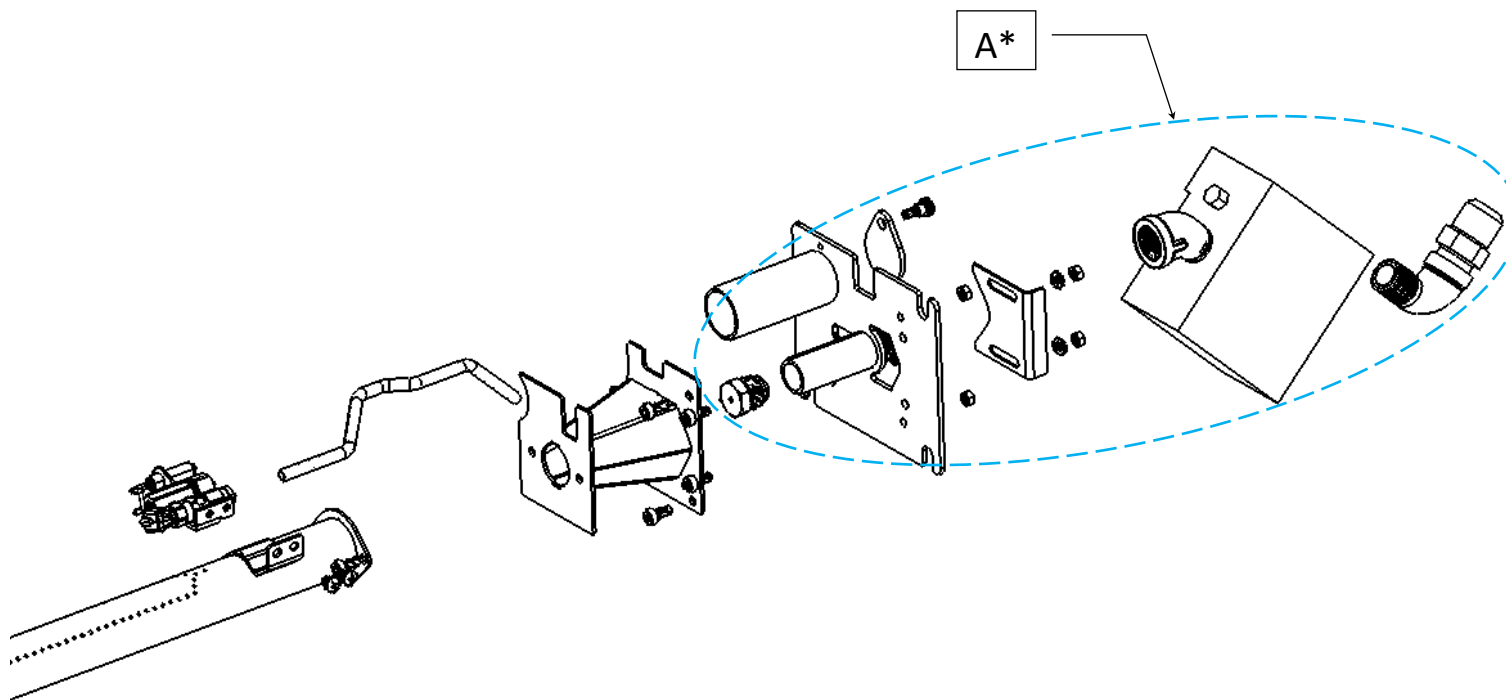

#	Part #	Description	Model
A*	VOL11-0047-A	GAS VALVE ASSEMBLY WITH FIXATION PLATE AND NOZZLE NATURAL GAS SERIAL NUMBER BEFORE 02767022025	XX33
A*	VOL11-0045-A	GAS VALVE ASSEMBLY WITH FIXATION PLATE AND NOZZLE NATURAL GAS SERIAL NUMBER BETWEEN 02767022025 & 02853082025	XX33
A*	VOL11-0049-A	GAS VALVE ASSEMBLY WITH FIXATION PLATE AND NOZZLE NATURAL GAS SERIAL NUMBER AFTER 02853082025	XX33
A*	VOL11-0048-A	GAS VALVE ASSEMBLY WITH FIXATION PLATE AND NOZZLE PROPANE GAS SERIAL NUMBER BEFORE 02767022025	XX33
A*	VOL11-0046-A	GAS VALVE ASSEMBLY WITH FIXATION PLATE AND NOZZLE PROPANE GAS SERIAL NUMBER BETWEEN 02767022025 & 02853082025	XX33
A*	VOL11-0050-A	GAS VALVE ASSEMBLY WITH FIXATION PLATE AND NOZZLE PROPANE GAS SERIAL NUMBER AFTER 02853082025	XX33
A*		GAS VALVE ASSEMBLY WITH FIXATION PLATE AND NOZZLE NATURAL GAS	XX26
A*		GAS VALVE ASSEMBLY WITH FIXATION PLATE AND NOZZLE PROPANE GAS	XX20

Description

GAS BURNER AND BLOWER VALVE 3 OF 4



A*

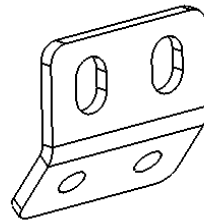
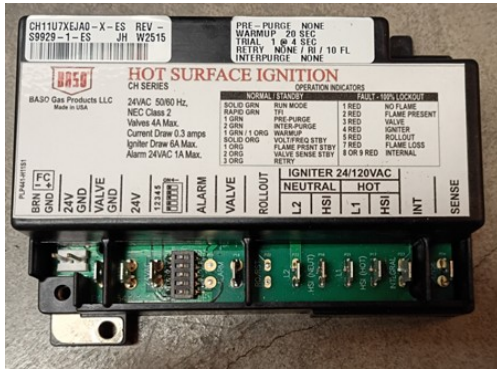
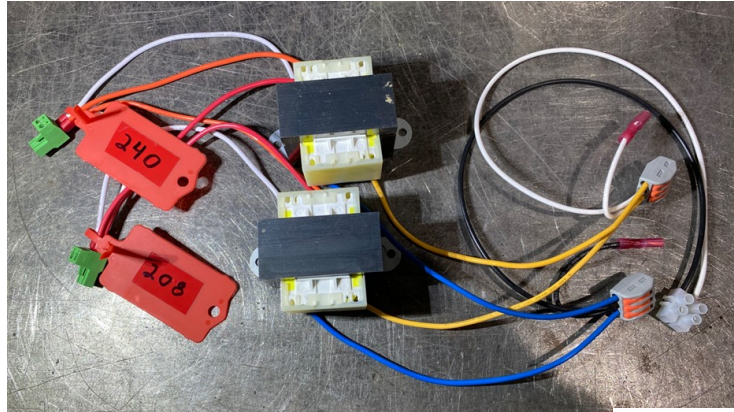

#	Part #	Description	Model
	VOL11-0052-A	CONVERSION KIT 120VAC TO 24 VAC IGNITION NATURAL GAS	XX33
	VOL11-0053-A	CONVERSION KIT 120VAC TO 24 VAC IGNITION PROPANE GAS	XX33

Description

GAS BURNER AND BLOWER VALVE 4 OF 4



B*	VOL11-0018-A	MESH ONLY	XX33
B*		MESH ONLY	XX26
B*		MESH ONLY	XX20
*MODEL SPECIFIC			

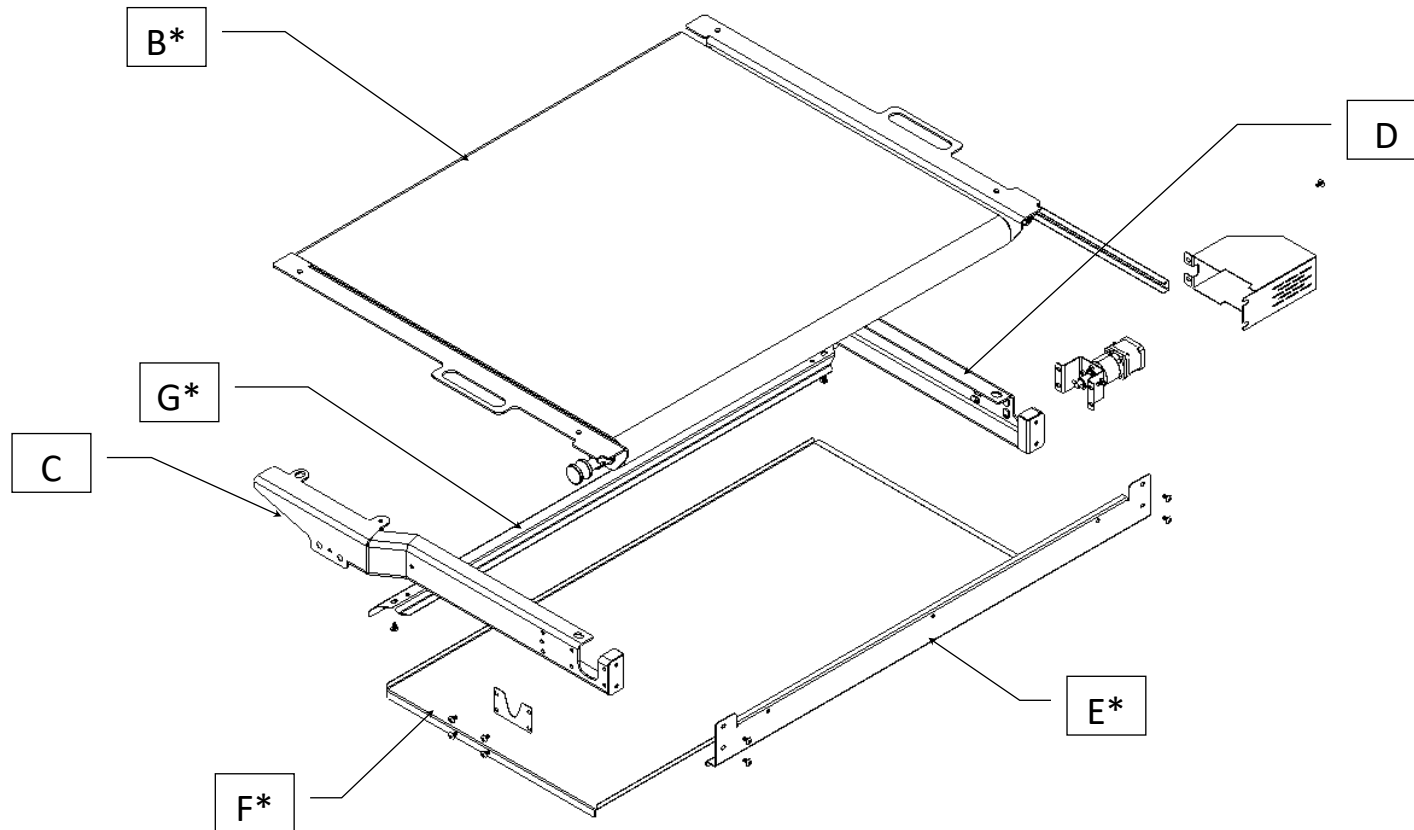
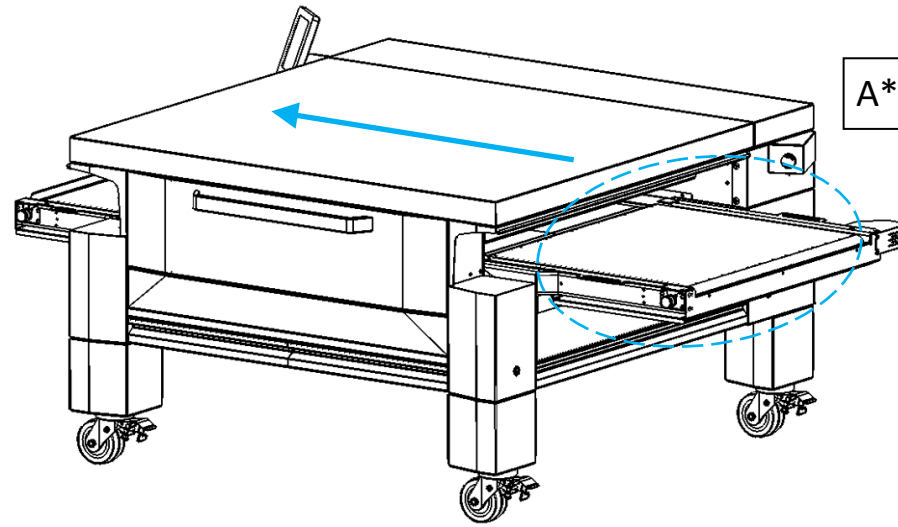

#	Part #	Description	Model
A*	HR05-0559-A	COMPLETE CONVEYOR ASSEMBLY WITH ARMS BEFORE SERIAL NO. 02767022025	XX33
A*	HR05-0559-B	COMPLETE CONVEYOR ASSEMBLY WITH ARMS AFTER SERIAL NO.02853082025	XX33
A*		COMPLETE CONVEYOR ASSEMBLY WITH ARMS	XX26
A*		COMPLETE CONVEYOR ASSEMBLY WITH ARMS	XX20
B*	HR05-0560-A	CONVEYOR ONLY	XX33
B*		CONVEYOR ONLY	XX26
B*		CONVEYOR ONLY	XX20
C	HR04-0413-E	FRONT ARM	ALL
D	HR04-0412-E	REAR ARM	ALL
E*	HR01-1557-D	CAPING PLATE	XX33
E*		CAPING PLATE	XX26
E*		CAPING PLATE	XX20
F*	HR01-1700-C	CRUMB TRAY	XX33
F*		CRUMB TRAY	XX26
F*		CRUMB TRAY	XX20
G*	HR01-1841-C	SUPPORT MEMBER	XX33
G*		SUPPORT MEMBER	XX26
G*		SUPPORT MEMBER	XX20

*MODEL SPECIFIC

Description

LONG ENTRY R TO L (RIGHT TO LEFT) CONVEYOR



B*	VOL11-0019-A	MESH ONLY	XX33
B*		MESH ONLY	XX26
B*		MESH ONLY	XX20
*MODEL SPECIFIC			

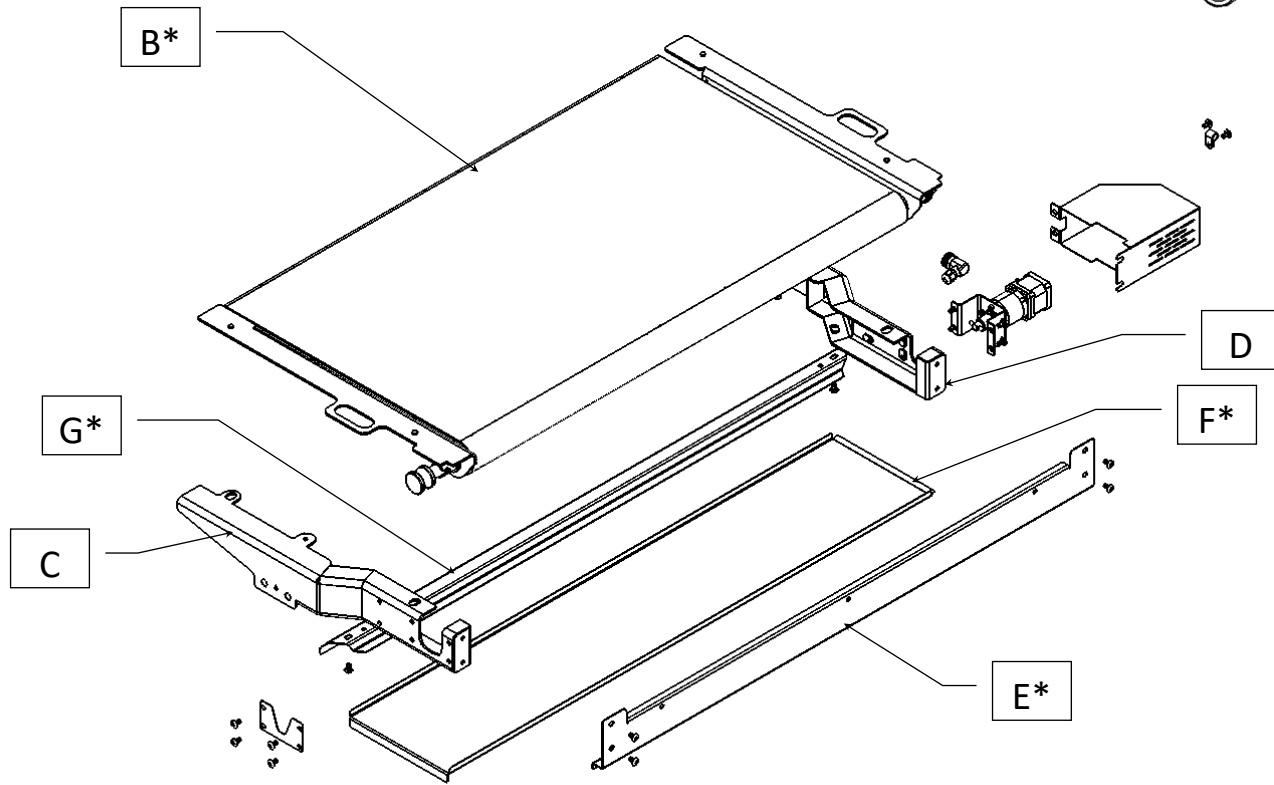
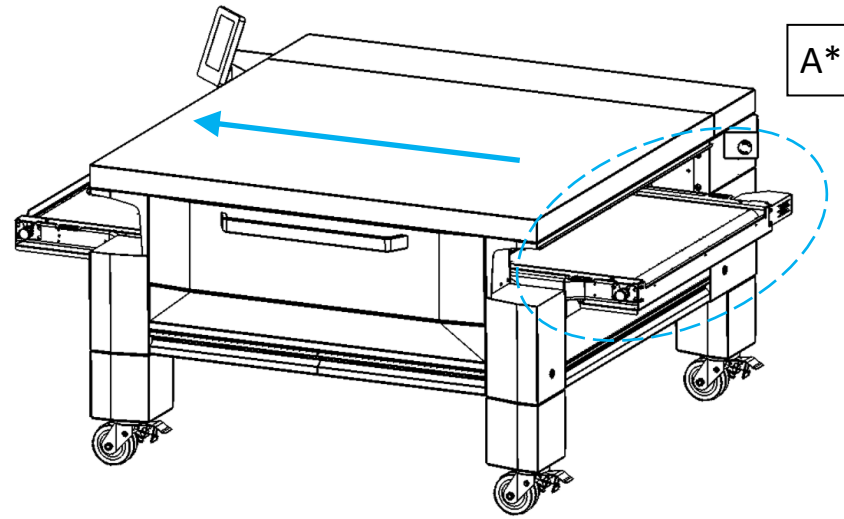

#	Part #	Description	Model
A*	HR05-0562-A	COMPLETE CONVEYOR ASSEMBLY WITH ARMS BEFORE SERIAL NO. 02767022025	XX33
A*	HR05-0562-B	COMPLETE CONVEYOR ASSEMBLY WITH ARMS AFTER SERIAL NO. 02853082025	XX33
A*		COMPLETE CONVEYOR ASSEMBLY WITH ARMS	XX26
A*		COMPLETE CONVEYOR ASSEMBLY WITH ARMS	XX20
B*	HR05-0552-A	CONVEYOR ONLY	XX33
B*		CONVEYOR ONLY	XX26
B*		CONVEYOR ONLY	XX20
C	HR04-0429-C	FRONT ARM	ALL
D	HR04-0428-C	REAR ARM	ALL
E*	HR01-1557-D	CAPING PLATE	XX33
E*		CAPING PLATE	XX26
E*		CAPING PLATE	XX20
F*	HR01-1842-B	CRUMB TRAY	XX33
F*		CRUMB TRAY	XX26
F*		CRUMB TRAY	XX20
G*	HR01-1841-C	SUPPORT MEMBER	XX33
G*		SUPPORT MEMBER	XX26
G*		SUPPORT MEMBER	XX20

*MODEL SPECIFIC

Description
SHORT ENTRY R TO L (RIGHT TO LEFT) CONVEYOR



B*	VOL11-0019-A	MESH ONLY	XX33
B*		MESH ONLY	XX26
B*		MESH ONLY	XX20
H*	HR01-1818-A	STOPPER PLATE	XX33
H*		STOPPER PLATE	XX26
H*		STOPPER PLATE	XX20

*MODEL SPECIFIC

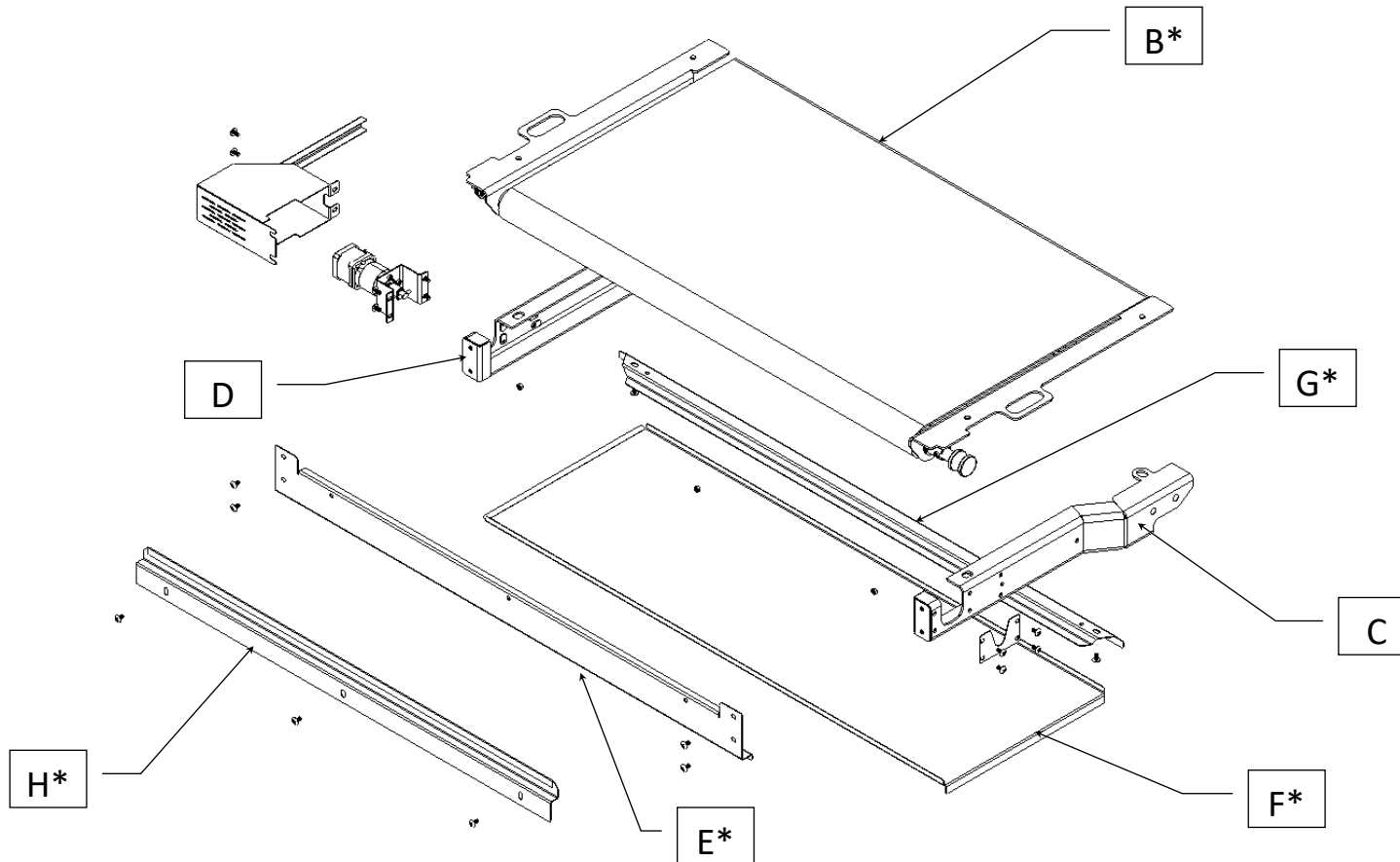
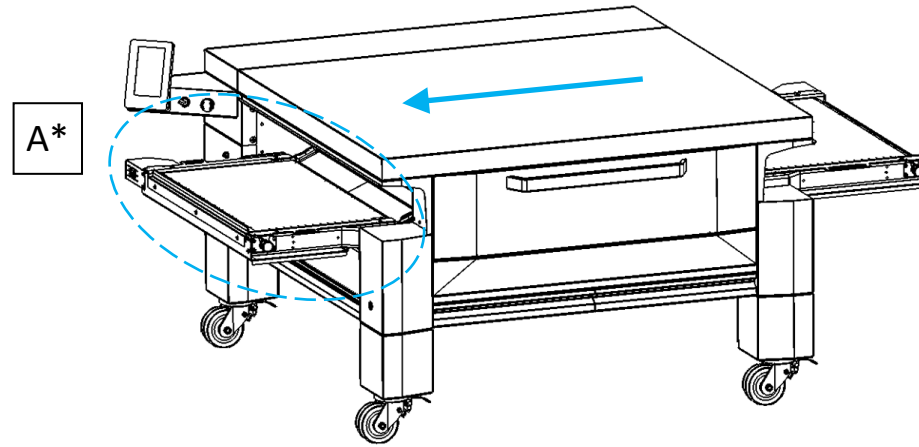

#	Part #	Description	Model
A*	HR05-0561-A	COMPLETE CONVEYOR ASSEMBLY WITH ARMS BEFORE SERIAL NO. 02767022025	XX33
A*	HR05-0561-B	COMPLETE CONVEYOR ASSEMBLY WITH ARMS AFTER SERIAL NO. 02853082025	XX33
A*		COMPLETE CONVEYOR ASSEMBLY WITH ARMS	XX26
A*		COMPLETE CONVEYOR ASSEMBLY WITH ARMS	XX20
B*	HR05-0555-A	CONVEYOR ONLY	XX33
B*		CONVEYOR ONLY	XX26
B*		CONVEYOR ONLY	XX20
C	HR04-0427-D	FRONT ARM	ALL
D	HR04-0426-D	REAR ARM	ALL
E*	HR01-1557-D	CAPING PLATE	XX33
E*		CAPING PLATE	XX26
E*		CAPING PLATE	XX20
F*	HR01-1574-D	CRUMB TRAY	XX33
F*		CRUMB TRAY	XX26
F*		CRUMB TRAY	XX20
G*	HR01-1841-C	SUPPORT MEMBER	XX33
G*		SUPPORT MEMBER	XX26
G*		SUPPORT MEMBER	XX20

*MODEL SPECIFIC

Description

SHORT EXIT R TO L (RIGHT TO LEFT) CONVEYOR



B*	VOL11-0018-A	MESH ONLY	XX33
B*		MESH ONLY	XX26
B*		MESH ONLY	XX20
*MODEL SPECIFIC			

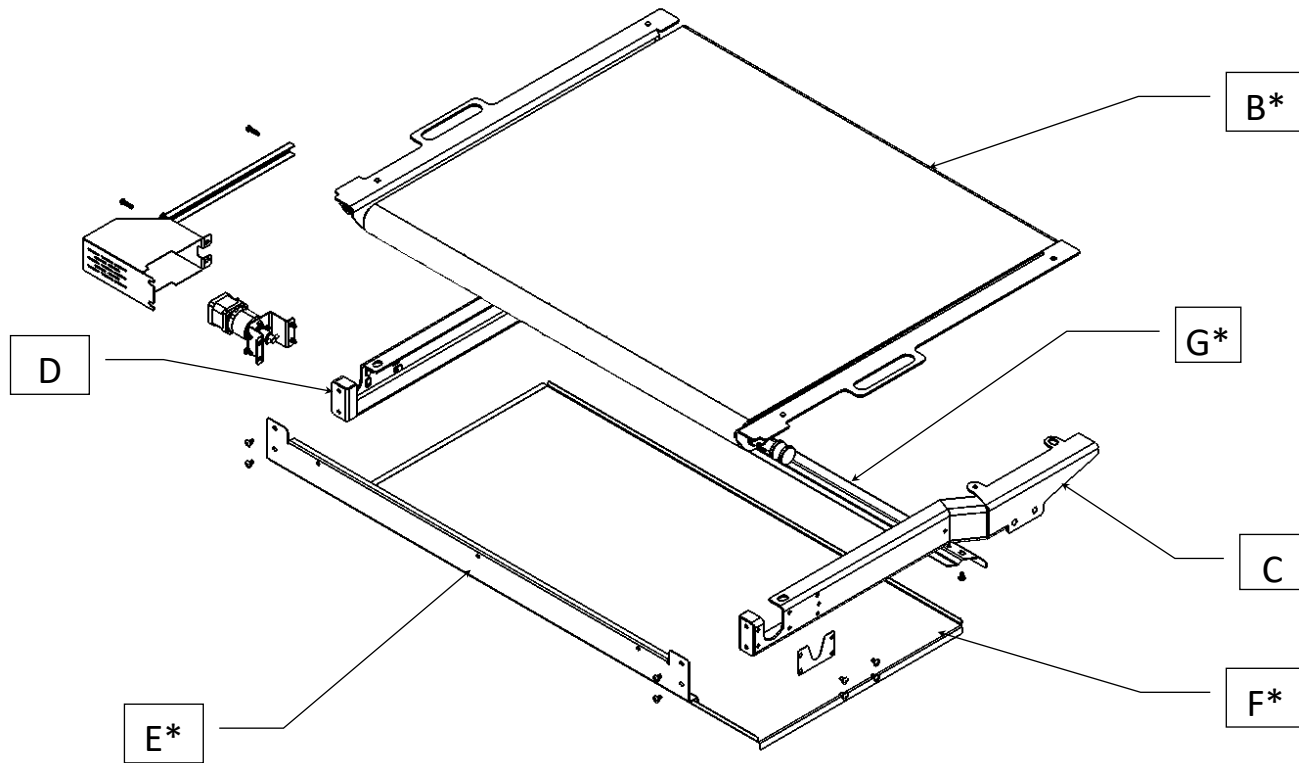
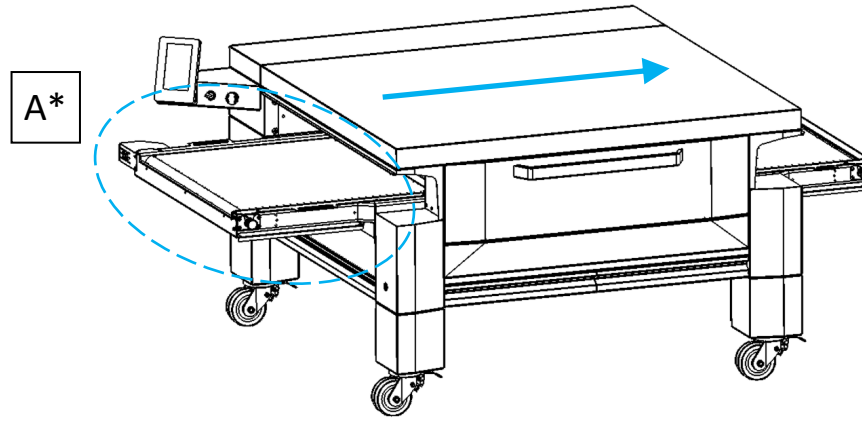

#	Part #	Description	Model
A*	HR05-0534-B	COMPLETE CONVEYOR ASSEMBLY WITH ARMS BEFORE SERIAL NO. 02767022025	XX33
A*	HR05-0534-C	COMPLETE CONVEYOR ASSEMBLY WITH ARMS AFTER SERIAL NO. 02853082025	XX33
A*		COMPLETE CONVEYOR ASSEMBLY WITH ARMS	XX26
A*		COMPLETE CONVEYOR ASSEMBLY WITH ARMS	XX20
B*	HR05-0535-A	CONVEYOR ONLY	XX33
B*		CONVEYOR ONLY	XX26
B*		CONVEYOR ONLY	XX20
C	HR04-0412-E	FRONT ARM	ALL
D	HR04-0413-E	REAR ARM	ALL
E*	HR01-1557-D	CAPING PLATE	XX33
E*		CAPING PLATE	XX26
E*		CAPING PLATE	XX20
F*	HR01-1700-C	CRUMB TRAY	XX33
F*		CRUMB TRAY	XX26
F*		CRUMB TRAY	XX20
G*	HR01-1841-C	SUPPORT MEMBER	XX33
G*		SUPPORT MEMBER	XX26
G*		SUPPORT MEMBER	XX20

*MODEL SPECIFIC

Description
LONG ENTRY L TO R (LEFT TO RIGHT) CONVEYOR



B*	VOL11-0019-A	MESH ONLY	XX33
B*		MESH ONLY	XX26
B*		MESH ONLY	XX20
*MODEL SPECIFIC			

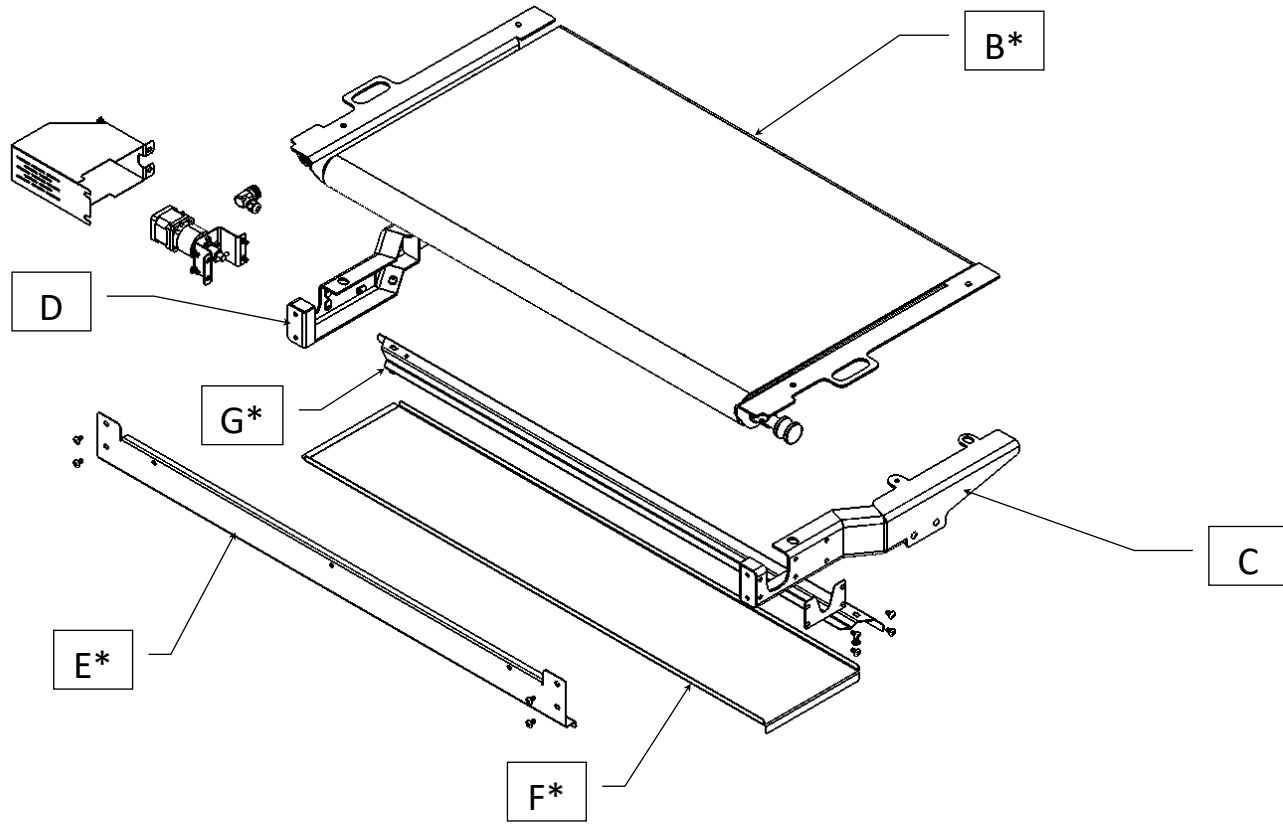
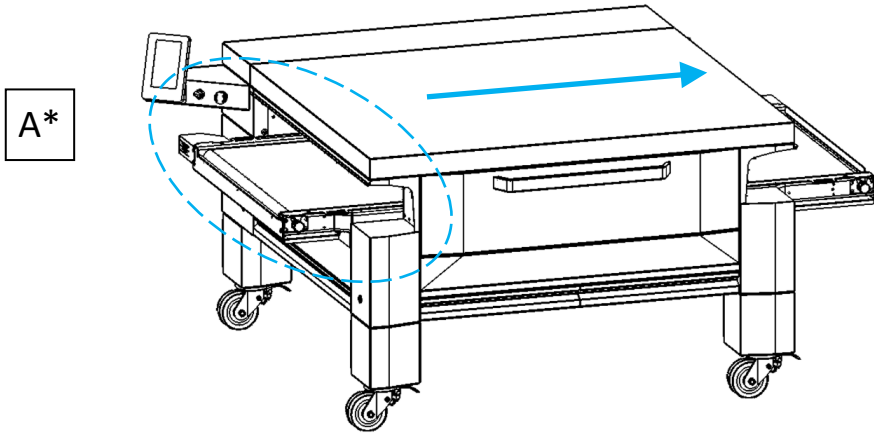

#	Part #	Description	Model
A*	HR05-0554-A	COMPLETE CONVEYOR ASSEMBLY WITH ARMS BEFORE SERIAL NO. 02767022025	XX33
A*	HR05-0554-B	COMPLETE CONVEYOR ASSEMBLY WITH ARMS AFTER SERIAL NO. 02853082025	XX33
A*		COMPLETE CONVEYOR ASSEMBLY WITH ARMS	XX26
A*		COMPLETE CONVEYOR ASSEMBLY WITH ARMS	XX20
B*	HR05-0555-A	CONVEYOR ONLY	XX33
B*		CONVEYOR ONLY	XX26
B*		CONVEYOR ONLY	XX20
C	HR04-0428-C	FRONT ARM	ALL
D	HR04-0429-C	REAR ARM	ALL
E*	HR01-1557-D	CAPING PLATE	XX33
E*		CAPING PLATE	XX26
E*		CAPING PLATE	XX20
F*	HR01-1842-B	CRUMB TRAY	XX33
F*		CRUMB TRAY	XX26
F*		CRUMB TRAY	XX20
G*	HR01-1841-C	SUPPORT MEMBER	XX33
G*		SUPPORT MEMBER	XX26
G*		SUPPORT MEMBER	XX20

*MODEL SPECIFIC

Description
SHORT ENTRY L TO R (LEFT TO RIGHT) CONVEYOR



B*	VOL11-0019-A	MESH ONLY	XX33
B*		MESH ONLY	XX26
B*		MESH ONLY	XX20
H*	HR01-1818-A	STOPPER PLATE	XX33
H*		STOPPER PLATE	XX26
H*		STOPPER PLATE	XX20

*MODEL SPECIFIC

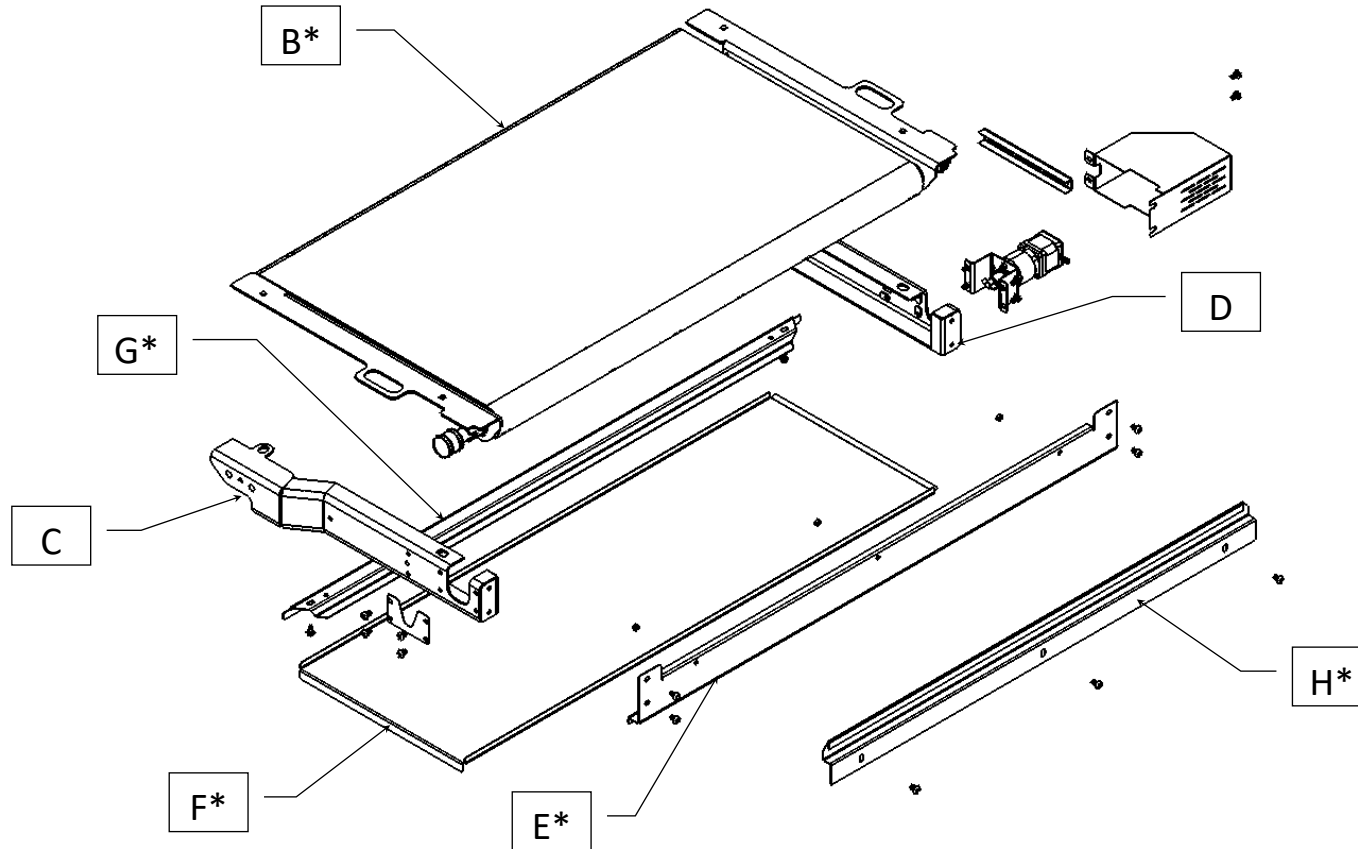
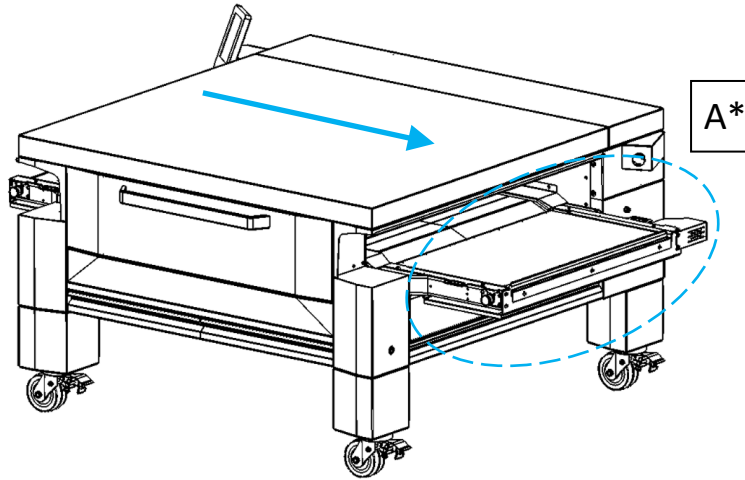

#	Part #	Description	Model
A*	HR01-0551-B	COMPLETE CONVEYOR ASSEMBLY WITH ARMS BEFORE SERIAL NO. 02767022025	XX33
A*	HR01-0551-C	COMPLETE CONVEYOR ASSEMBLY WITH ARMS AFTER SERIAL NO. 02853082025	XX33
A*		COMPLETE CONVEYOR ASSEMBLY WITH ARMS	XX26
A*		COMPLETE CONVEYOR ASSEMBLY WITH ARMS	XX20
B*	HR05-0552-A	CONVEYOR ONLY	XX33
B*		CONVEYOR ONLY	XX26
B*		CONVEYOR ONLY	XX20
C	HR04-0426-D	FRONT ARM	ALL
D	HR04-0427-D	REAR ARM	ALL
E*	HR01-1557-D	CAPING PLATE	XX33
E*		CAPING PLATE	XX26
E*		CAPING PLATE	XX20
F*	HR01-1574-D	CRUMB TRAY	XX33
F*		CRUMB TRAY	XX26
F*		CRUMB TRAY	XX20
G*	HR01-1841-C	SUPPORT MEMBER	XX33
G*		SUPPORT MEMBER	XX26
G*		SUPPORT MEMBER	XX20

*MODEL SPECIFIC

Description
SHORT EXIT L TO R (LEFT TO RIGHT) CONVEYOR



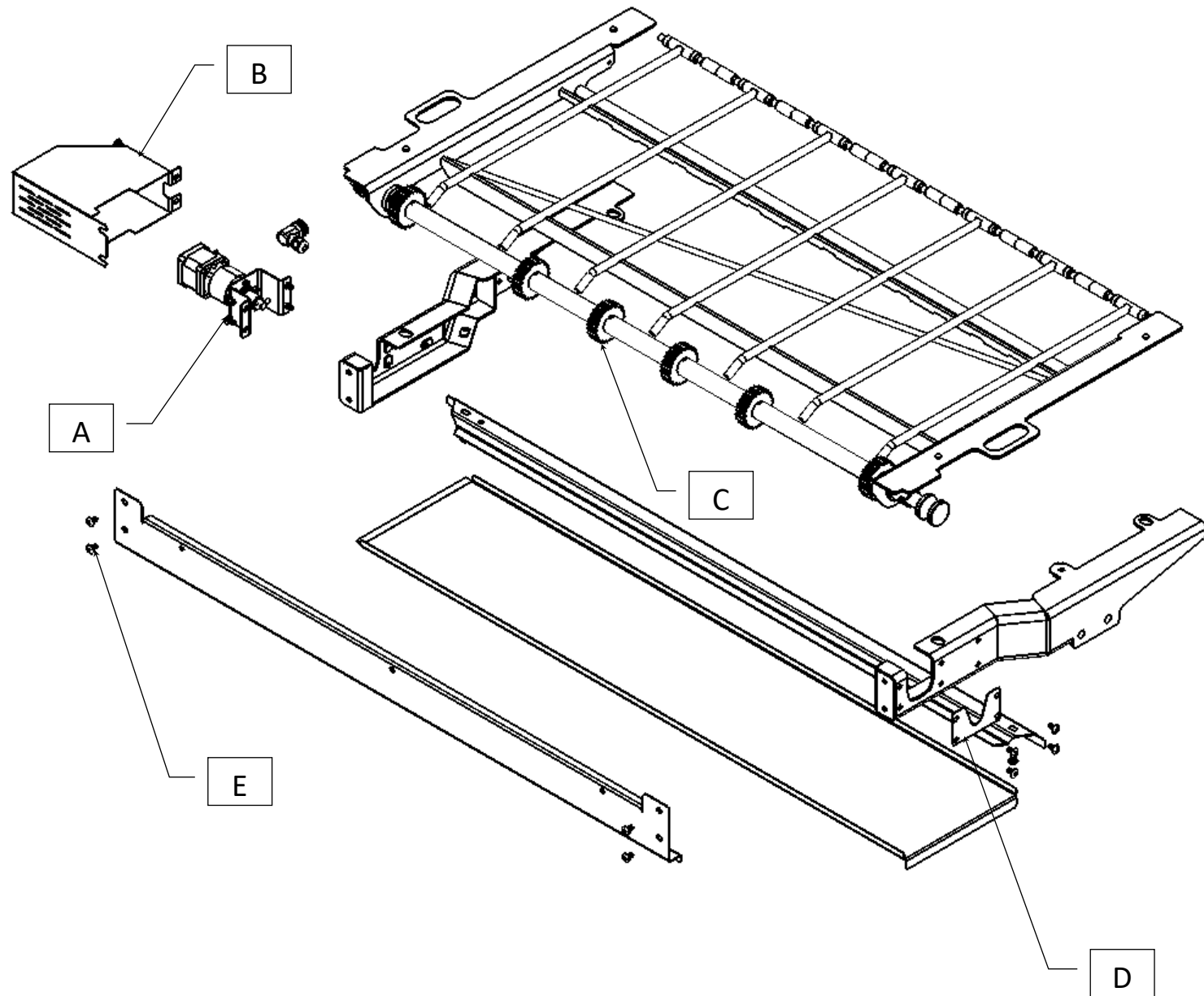

#	Part #	Description	Model
A	VOL11-0022-A	MOTOR ASSEMBLY	ALL
B	HR04-0416-C	CAPING BOX	ALL
C	ME57-0135	DRIVING GEAR	ALL
D	HR01-1774-A	MOTOR CUTOUT CAPING	ALL
E	051-0929	SCREW PHILIPS 5/16-18 X 3/4" STAINLESS	ALL

Description

ENTRY / EXIT CONVEYORS UNIVERSAL PARTS



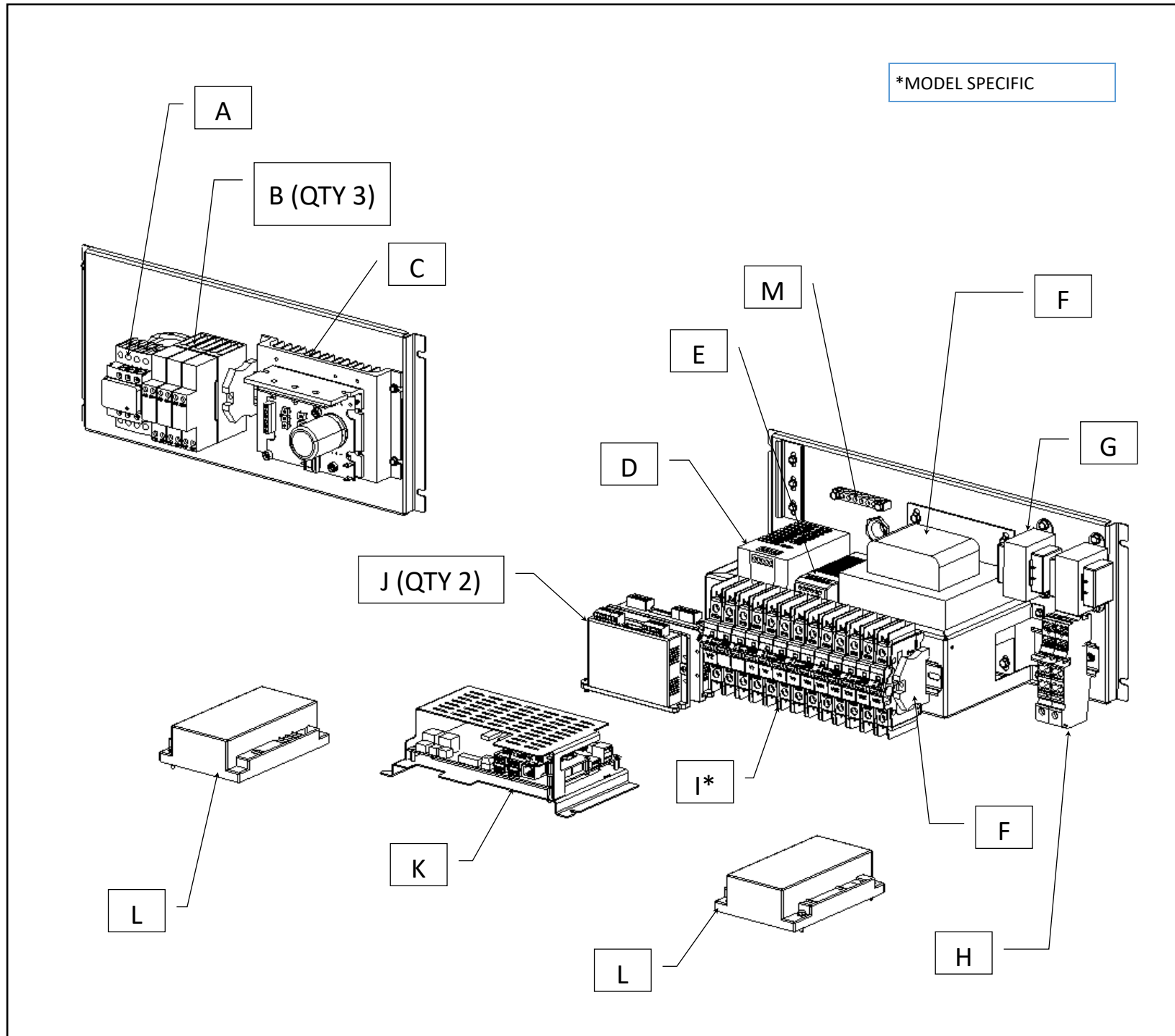

#	Part #	Description	Model
A	025-0405	MOTOR CONTACTOR 4POLE 25A, 24VDC	ALL
B	VOL11-0007-A	SSR 1 POLE 25A	ALL
C	VOL11-0020-A	VARIABLE FREQUENCY DRIVE VFD 1HP 4A	ALL
D	VOL11-0026-A	POWER SUPPLY 24VDC 240W	ALL
E	VOL11-0025-A	POWER SUPPLY 5VDC 30W	ALL
F	029-0087	TRANSFO 1000VA,120-240/120-240	ALL
G	EL40-0037	TRANSFORMER 40VA 208/240V - 24VAC	ALL
H	028-2017	PUSH-IN POWER DISTRIBUTION BLOC	ALL
I*	034-3120	BREAKER UL-489 2 POLES 25A QTY 2	ALL
I*	034-3106	BREAKER UL-489 2 POLES 10A QTY 1	ALL
I*	034-3101	BREAKER UL-489 2 POLES 4A QTY 2	ALL
I*	034-3115	BREAKER UL-489 2 POLES 2A QTY 1	ALL
I*	034-3110	BREAKER UL-489 1 POLE 2A QTY 1	ALL
J	VOL11-0023-A	STEPPER MOTOR DRIVE	ALL
K	VOL11-0062-A	VOLCANO CONTROL BOARD ASSEMBLY WITH MCC134 TEMPERATURE CARD AND THERMOCOUPLES	ALL
L	VOL11-0042-A	IGNITION CONTROL MODULE 24VAC FOR SERIAL NO. AFTER 02824092025	ALL
L	VOL11-0012-A	IGNITION CONTROL MODULE 120VAC AFTER SERIAL NUMBER 02824092025 DO NOT USE REPLACE BY UPDATE KIT VOL11-0052-A -0053-A	ALL
M	028-0110	GROUND BARRIER (8 HOLES)	ALL

Description

ELECTRICAL PANEL (PAGE 1 OF 1)





A



B



C

D



E



F

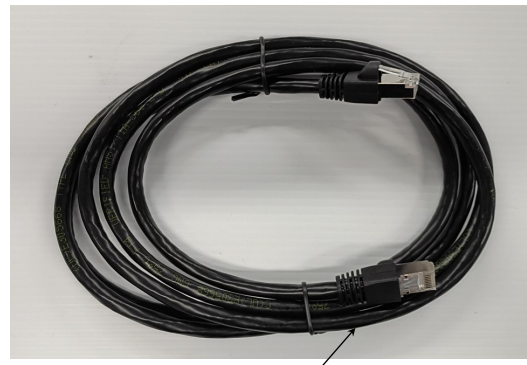

G



H

I

#	Part #	Description	Model
A	HR06-0023-A	CONTROL HARNESS	ALL
B	HR06-0024-A	POWER HARNESS	ALL
C	040-0113	HDMI SCREEN CABLE	ALL
D	040-0121	HDMI 270 DEG. ADAPTER	ALL
E	040-0120	USB MALE TYPE A STRAIGHT TO MICRO USB TYPE B 90 DEG.	ALL
F	040-0124	USB MALE TYPE A STRAIGHT TO USB FEMALE TYPE A STRAIGHT	ALL
G	040-0090	ETHERNET CABLE	ALL
H	040-0127	USB MALE TYPE A STRAIGHT TO MICRO	ALL
I	040-0126	USB MALE TYPE A STRAIGHT TO USB	ALL

*MODEL SPECIFIC

Description

CABLES, WIRES AND HARNESS





A

#	Part #	Description	Model
A	VOL11-0068-A	LAST PROGRAM VERSION USB KEY	ALL

Description

SOFTWARE

